

Flat 4, 31 Dagmar Road, London, N4 4NY

Asking Price £745,000

Hobarts Estate Agents are proud to present this exceptional 2-bedroom ground-floor flat with a private garden, nestled within an exclusive collection of luxury newly-built residences. Crafted to the highest standards, this elegant home showcases a bright and spacious open-plan living area, perfectly paired with a state-of-the-art, fully fitted kitchen—ideal for contemporary living and entertaining in style. The property features two generously proportioned double bedrooms, including a luxurious en-suite in the principal bedroom, as well as a sleek, modern main bathroom, blending comfort and sophistication seamlessly. With the added benefits of a long lease and a share of freehold, this property truly has it all. Don't miss the chance to make it yours!

Hobarts Estate Agents  
23 Ferme Park Road, Stroud Green, London, N4 4DS  
[stroudgreen@hobarts.co.uk](mailto:stroudgreen@hobarts.co.uk)  
[www.hobartsproperty.co.uk](http://www.hobartsproperty.co.uk)  
442083429000





- Private garden
- Energy efficient led lighting
- Audio-visual intercom entry system
- Double glazing
- Ground-floor flat
- Building under guarantee
- En-suite
- New Development
- Contemporary high spec bathrooms
- USB plug sockets
- Underfloor heating
- Council Tax TBC

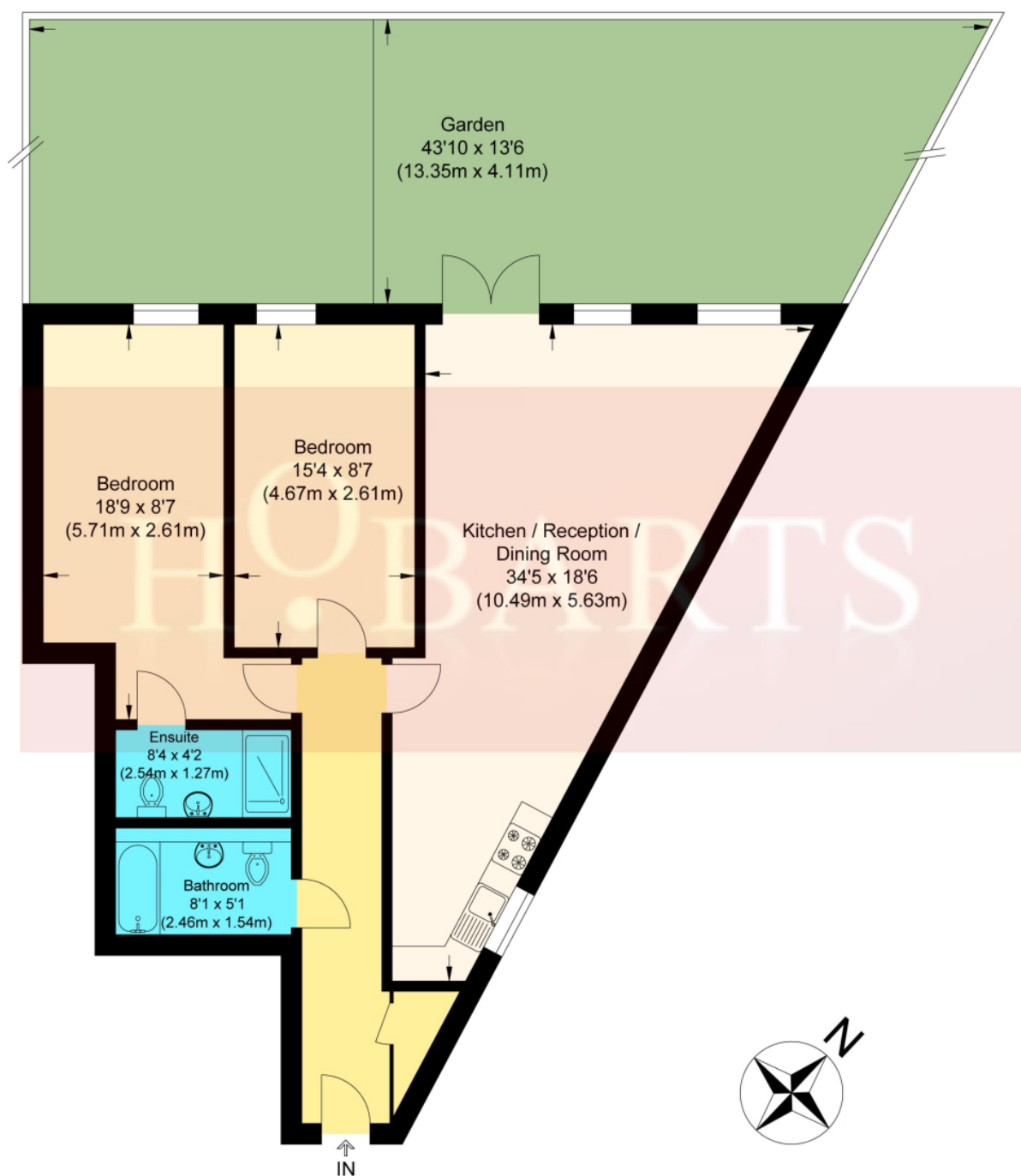

**Ground Floor**

**Dagmar Road**

Approximate Gross Internal Floor Area : 78.70 sq m / 847.11 sq ft

Illustration for identification purposes only, measurements are approximate, not to scale.





Score	Energy rating	Current	Potential
92+	<b>A</b>		
81-91	<b>B</b>	81 B	81 B
69-80	<b>C</b>		
55-68	<b>D</b>		
39-54	<b>E</b>		
21-38	<b>F</b>		
1-20	<b>G</b>		

**Tenure:**  
Share of Freehold

**Ground rent:**

**Service Charges:**

**Local Authority:**

**Viewings:**

Strictly by appointment via  
HOBARTS ESTATE AGENTS  
442083429000

**Contact:**

23 Ferme Park Road, Stroud  
Green, London, N4 4DS

stroudgreen@hobarts.co.uk  
www.hobartsproperty.co.uk

rightmove

PrimeLocation.com

homes24.co.uk

Zoopla.co.uk

propertyfinder.com



These property details, including measurements, floor plans and items depicted in photographs etc. are intended only as a brief guide to prospective purchasers and are not intended to be relied upon for any purpose whatsoever. Any interested party should satisfy themselves by inspection or otherwise as to the correctness of each statement contained in these details.