



Marriott Road, London, N4 3QL

Asking Price £525,000

This delightful one-bedroom maisonette is presented in excellent condition and boasts a lovely private garden, perfect for outdoor dining with space for a table and chairs. Other standout features include a stylish kitchen with a breakfast bar, a sleek modern bathroom, and a generously sized bedroom. Flooded with natural light through large windows, this property offers a bright and inviting atmosphere. Situated in a prime location, it's within walking distance of local shops, amenities, and excellent transport links, including Crouch Hill and Finsbury Park tube stations. Don't miss the chance to make this wonderful property your new home!

Hobarts Estate Agents
23 Ferme Park Road, Stroud Green, London, N4 4DS
stroudgreen@hobarts.co.uk
www.hobartsproperty.co.uk
442083429000



- Well-Maintained Maisonette
- Bright Living Space
- Modern Bathroom
- Prime Location

- Private Garden
- Kitchen with a breakfast bar
- Spacious Bedroom
- Within walking distance of Finsbury Park Station

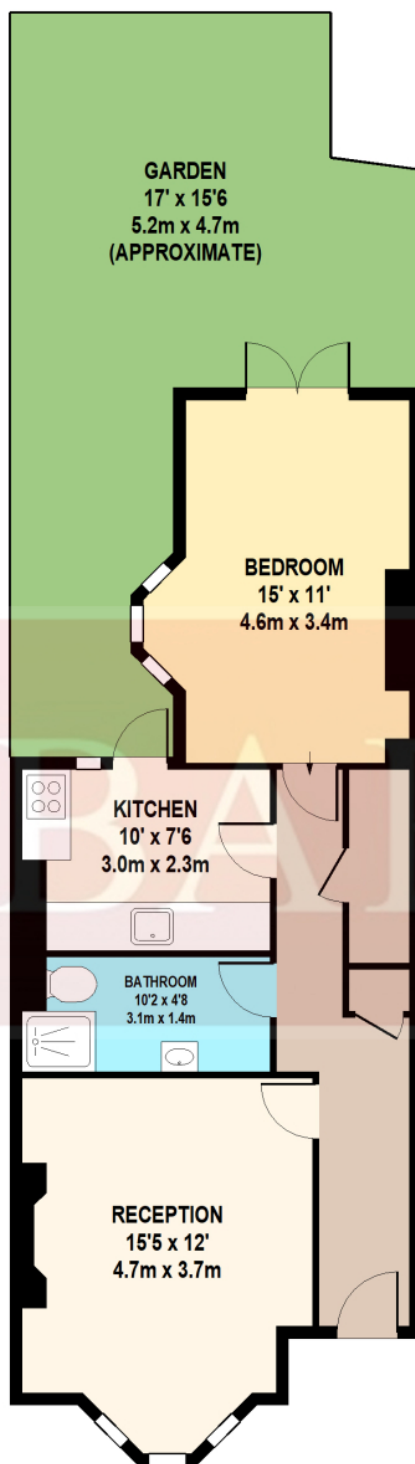

GROUND FLOOR

MARRIOTT ROAD
TOTAL APPROX. FLOOR AREA 556 SQ.FT. (52 SQ.M.)

Whilst every attempt has been made to ensure the accuracy of the floor plan contained here, measurements of doors, windows, rooms and any other items are approximate and no responsibility is taken for any error, omission, or mis-statement.
This plan is for illustrative purposes only and should be used as such by any prospective purchaser.
The services, system and appliances shown have not been tested and no guarantee as to their operability or efficiency can be given.

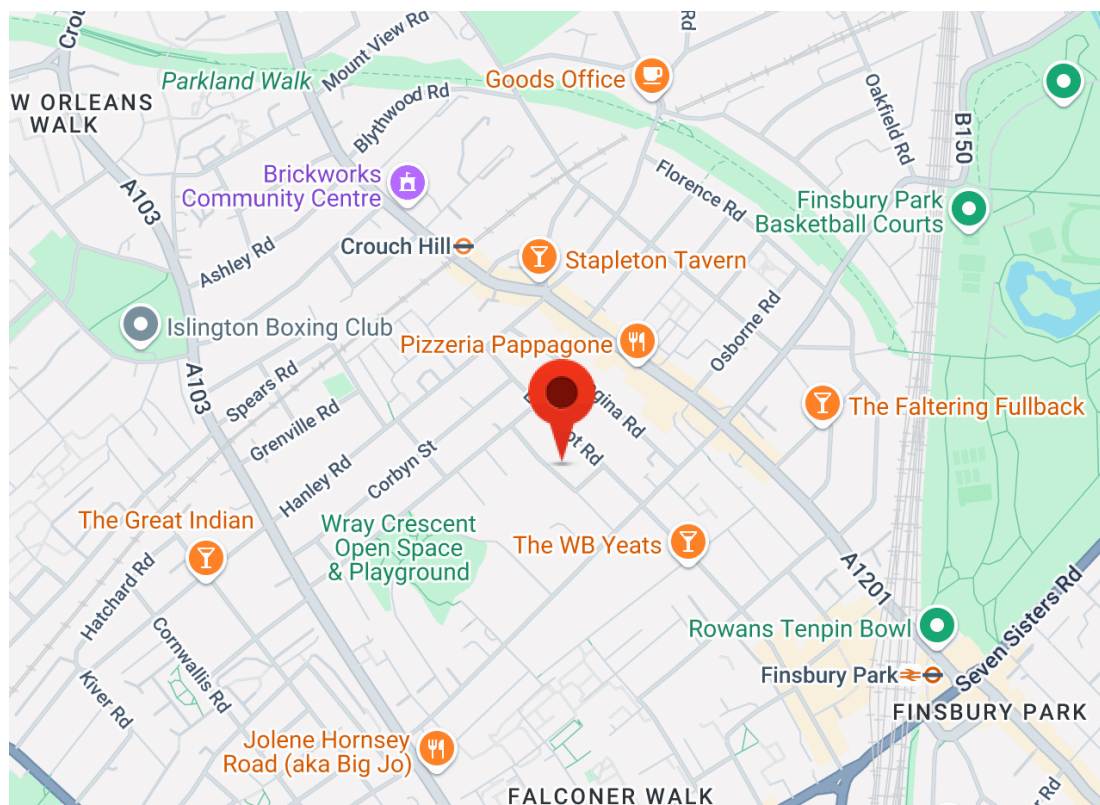

Score	Energy rating	Current	Potential
92+	A		
81-91	B		
69-80	C		78 C
55-68	D	67 D	
39-54	E		
21-38	F		
1-20	G		

Tenure:

Leasehold

Ground rent:

Service Charges:

Local Authority:

Viewings:

Strictly by appointment via
HOBARTS ESTATE AGENTS
442083429000

Contact:

23 Ferme Park Road, Stroud
Green, London, N4 4DS

stroudgreen@hobarts.co.uk
www.hobartsproperty.co.uk

rightmove

PrimeLocation.com

homes24.co.uk

Zoopla.co.uk

propertyfinder.com



These property details, including measurements, floor plans and items depicted in photographs etc. are intended only as a brief guide to prospective purchasers and are not intended to be relied upon for any purpose whatsoever. Any interested party should satisfy themselves by inspection or otherwise as to the correctness of each statement contained in these details.