

FLAT 7 35 SHERWOOD GARDENS - ROOM 1

LONDON, E14 9GA

£1,000 PER MONTH

Modern Flat Share near Canary Wharf – All Bills In & Students welcome!

Discover this newly converted, fully furnished flat just 7 minutes' walk from the DLR station, providing quick access to Canary Wharf and the City. Ideal for students and young professionals alike, this stylish property offers:

Bright, spacious rooms - Room 1 & 4 ARE STILL AVAILABLE!

Fully equipped kitchen

Modern bathroom facilities

R
rice resi

FLAT 7 35 SHERWOOD GARDENS

Bedroom 1

Sharing Kitchen

Sharing Bathroom

Gated Development



FLAT 7 35 SHERWOOD GARDENS



ADDITIONAL INFORMATION

Local Authority –

Council Tax – Band

Viewings – By Appointment Only

Floor Area – 160.72 sq ft

Tenure –

**35 Sherwood Gardens,
London E14 9GA**

DETAILS

Total area : 703 sq ft/65.8 sq m
Floors: Ground Floor

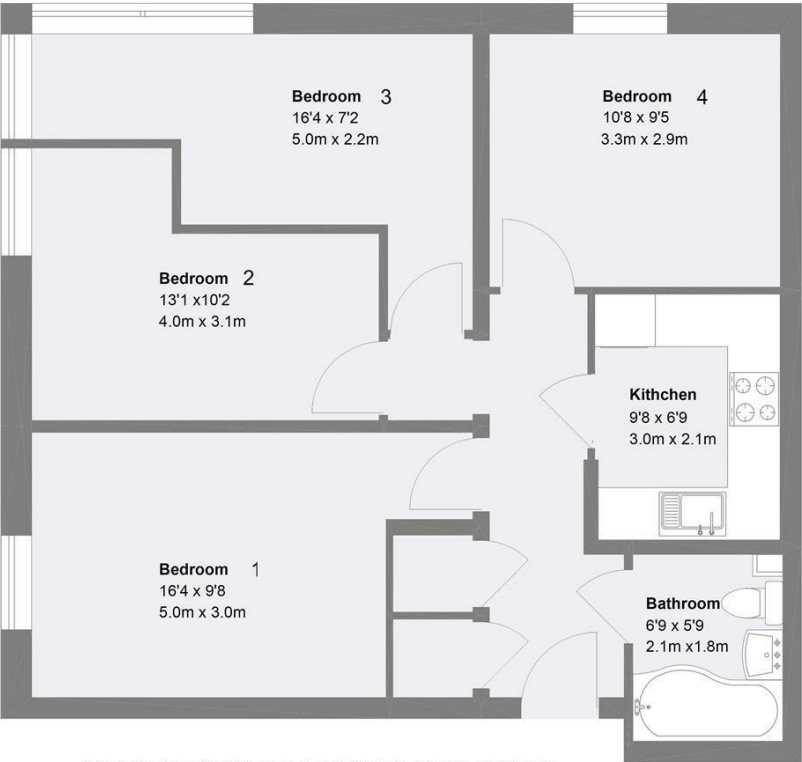

SIZES AND DIMENSIONS ARE APPROXIMATE, ACTUAL MAY VARY

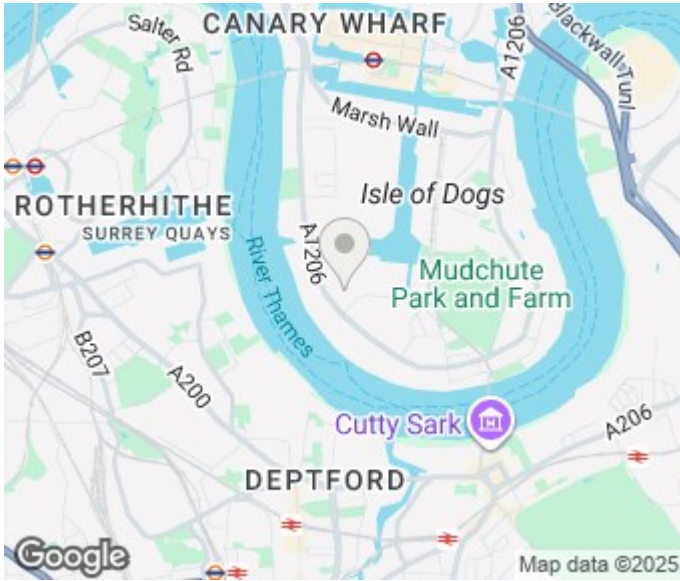

Energy Efficiency Rating		
	Current	Potential
Very energy efficient - lower running costs		
(92 plus) A		
(81-91) B		
(69-80) C		
(55-68) D		
(39-54) E		
(21-38) F		
(1-20) G		
Not energy efficient - higher running costs		
England & Wales	EU Directive 2002/91/EC	

Agents Note: Whilst every care has been taken to prepare these particulars, they are for guidance purposes only. All measurements are approximate and are for general guidance purposes only and whilst every care has been taken to ensure their accuracy, they should not be relied upon and potential buyers/tenants are advised to recheck the measurements

RICE Resi
Unit 6 12 Pepper Street
London
E14 9RP

020 3006 6995
hello@riceresi.com
www.riceresi.com

