



Rotherhithe Street, SE16

£475,000

Situated in this sought after riverside development, this two double bedroom flat is in stunning condition and offers a spacious living room, modern kitchen and bathroom, private terrace and is being sold chain free.

The apartment is perfectly located only 0.7 miles from Rotherhithe station and 0.8 miles from Canada Water station. The development is surrounded by shops, café's, riverside pubs and restaurants.

Features

- Two Double Bedrooms
- Fantastic Condition
- Private Terrace
- Chain Free
- Parking
- Riverside Location

Rotherhithe Street, London, SE16

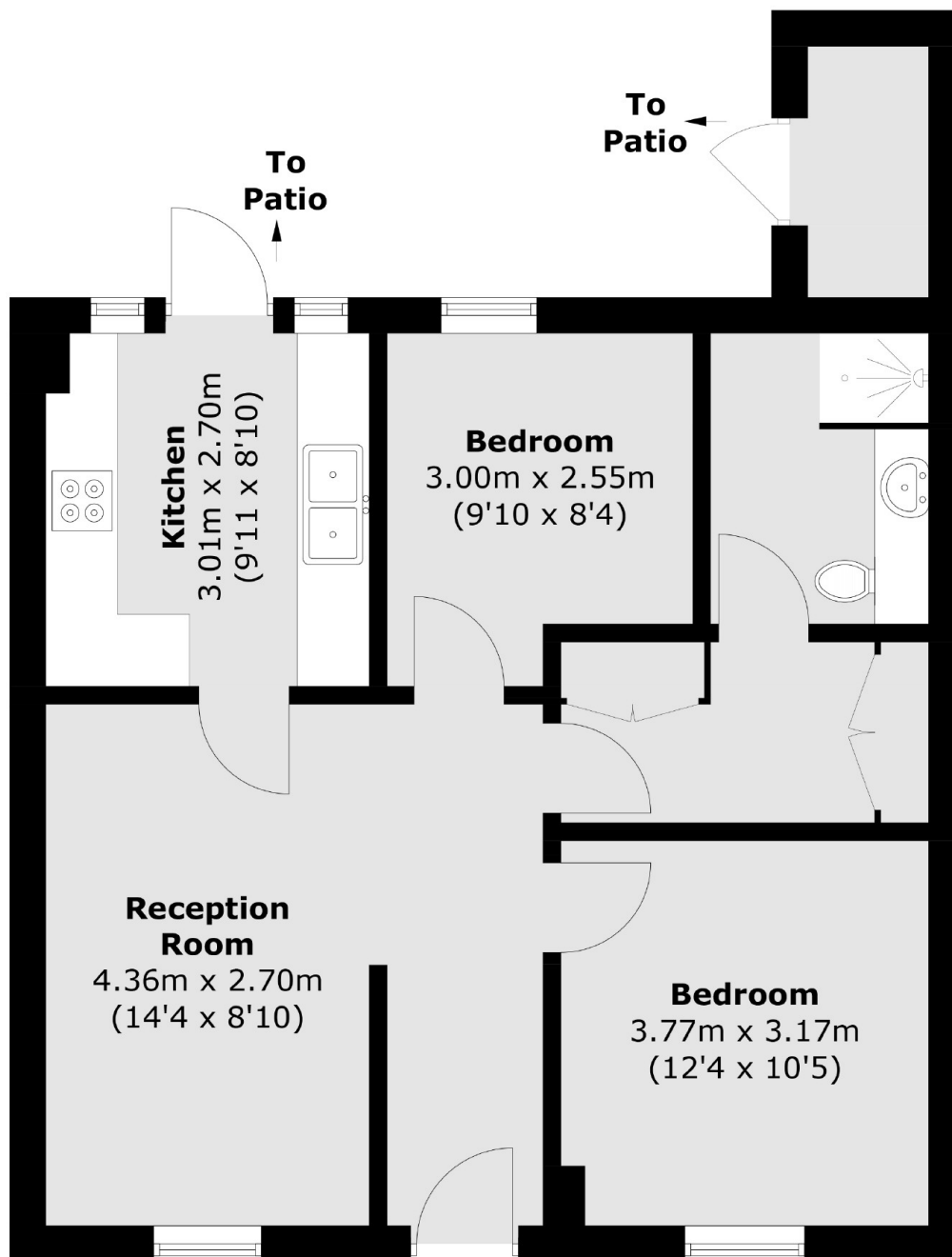

Total area (approx.): 55.2 sq. m (594.2 sq. ft)
External Cupboard: 2.2 sq. m (23.7 sq. ft)