



THE PROPERTY
EXPLORER



605 Skyline Plaza, Alencon Link, Basingstoke, Hants, RG21 7AX
£1,200 PCM





605 Skyline Plaza, Alencon Link, Basingstoke, Hants, RG21 7AX

£1,200 PCM

Property Explorer are delighted to present to market this immaculate two bedroom apartment located on the 6th floor of Skyline Plaza. Situated just a few minutes walk to the mainline train station and town centre the property also benefits from; Two double bedrooms, good size lounge, kitchen area, modern neutral decor throughout, wardrobe and cupboard storage, intercom and lift access and allocated underground parking space. FURNISHED. NO PETS. NO SMOKING!
AVAILABLE MAY!

Tenant Information: Assuming rent agreed at £1,200.00 per month the Holding Deposit £276.92 is payable once offer accepted 'Subject to contract' to go towards first months rent and 5 x weeks Security Deposit £1,384.61 + Remaining First months rent £923.08 payable 2 working days before check in.

NB. Applicants must earn min 30 x rental (£1,200.00 pcm x 30) = £36,000 household income per year

- Two Double Bedrooms
- Underground Parking
- 6th Floor
- Balcony
- Furnished
- Available MAY 2025



Furnished

Council Tax Band: C

Available: 6th May 2025

Deposit: £1,384

Floor Plans

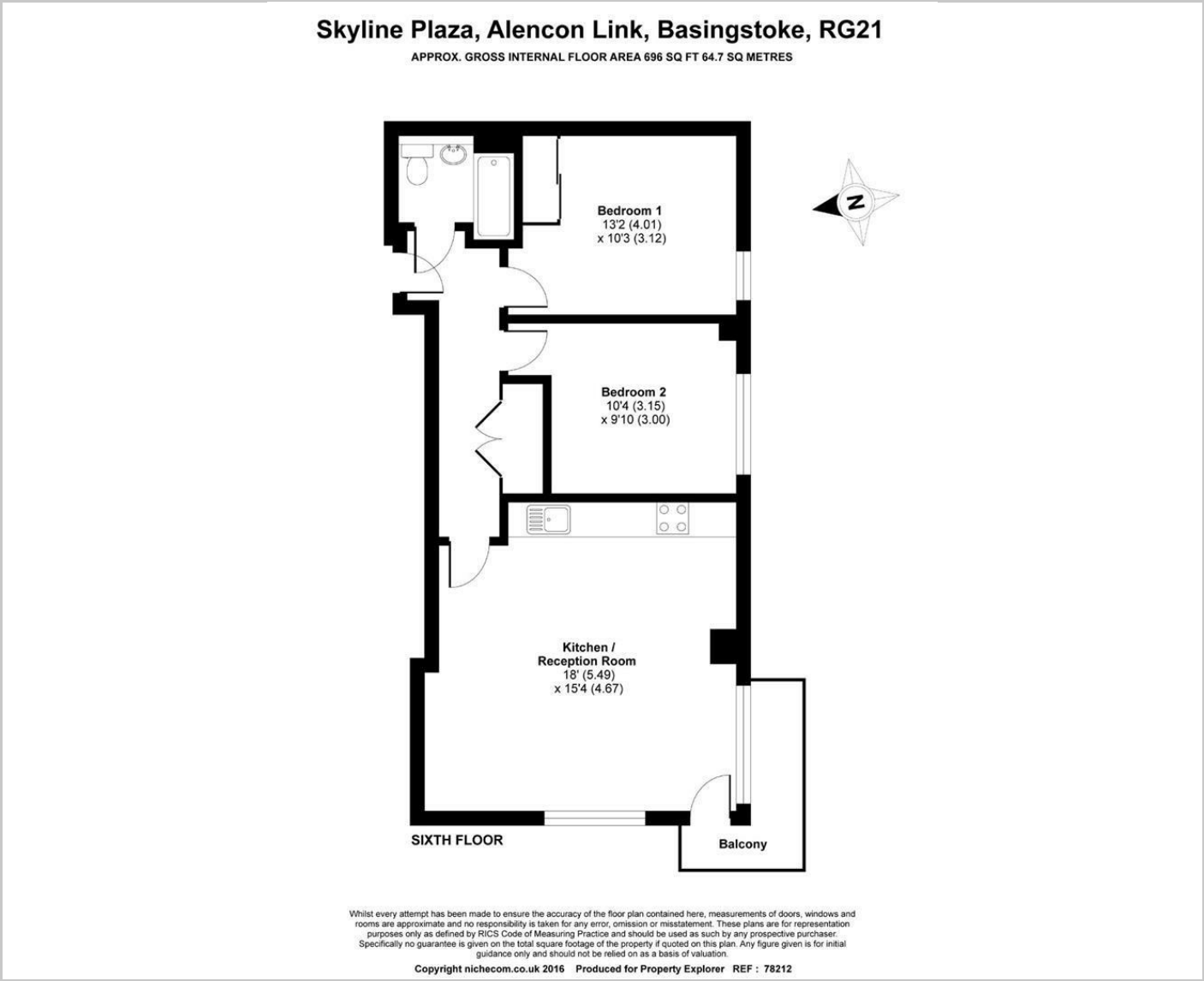

Area Map

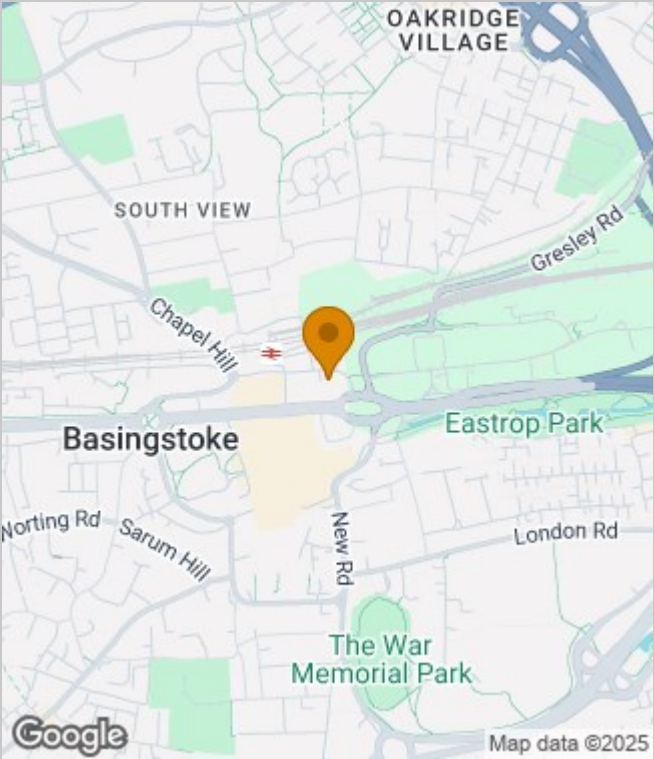

Energy Performance Graph

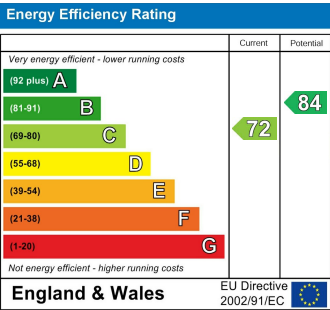

These particulars, whilst believed to be accurate are set out as a general outline only for guidance and do not constitute any part of an offer or contract. Intending purchasers should not rely on them as statements of representation of fact, but must satisfy themselves by inspection or otherwise as to their accuracy. No person in this firms employment has the authority to make or give any representation or warranty in respect of the property.