



THE PROPERTY
EXPLORER



15 Wood Close

Basingstoke, Hants, RG22 4XU

£1,950 PCM



4



3



2



D

15 Wood Close

Basingstoke, Hants, RG22 4XU

- 4 BEDROOM DETACHED PROPERTY
- GARAGE
- GARDEN
- AVAILABLE 1st MAY
- UNFURNISHED
- DRIVEWAY





Explorer Lettings are delighted to present this spacious four bedroom, three bathroom detached house. Featuring two spacious reception rooms, a bright and airy interior, and a flexible layout, this property is perfect for families and professionals. No Pets, Non-smokers only. Unfurnished. Available from the 1st of May 2025.

Tenant Information: Assuming rent agreed at £1950 per month the Holding Deposit £450 is payable once offer accepted 'Subject to contract' to go towards first months rent and 5 x weeks Security Deposit £2250 + Remaining First months rent £1500 payable 2 working days before check in.

NB. Applicants must earn min 30 x rental (£1950 pcm x 30) = £58,500 per year

[Full Description](#)



Floor Plan

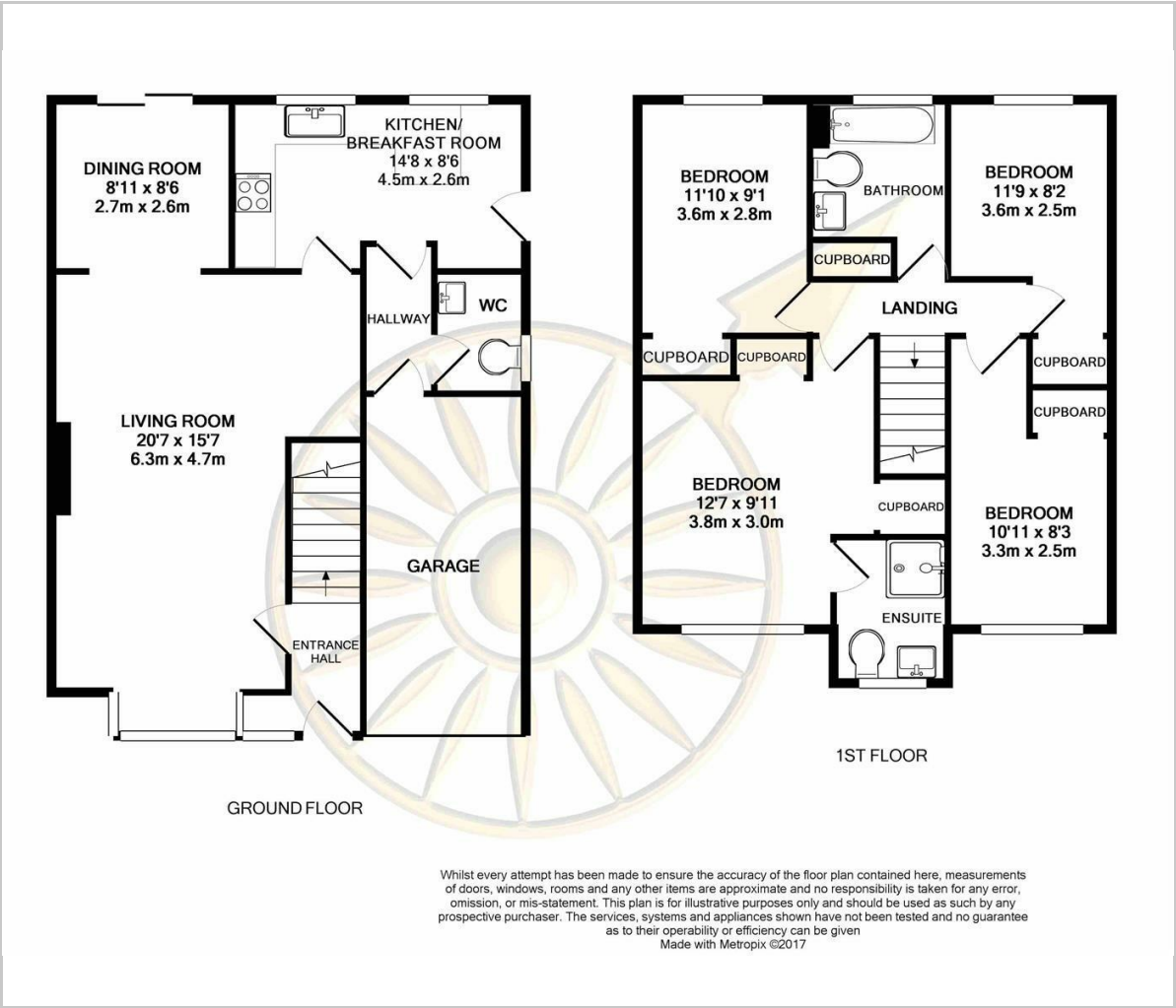

Viewing

Please contact our The Property Explorer Office on 01256 321777 if you wish to arrange a viewing appointment for this property or require further information.

These particulars, whilst believed to be accurate are set out as a general outline only for guidance and do not constitute any part of an offer or contract. Intending purchasers should not rely on them as statements of representation of fact, but must satisfy themselves by inspection or otherwise as to their accuracy. No person in this firms employment has the authority to make or give any representation or warranty in respect of the property.

Arena Business Centre, Suite GF11 The Square, Basing View, Basingstoke, Hampshire, RG21 4EB
Tel: 01256 321777 Email: hello@thepropertyexplorer.co.uk <https://www.thepropertyexplorer.co.uk>

Area Map



Energy Efficiency Graph

