

Introducing a spacious 2-bedroom apartment that is a Victorian gem.

Prestigiously situated in a prime location with a long lease and a share of freehold.

Convenience is at your doorstep with 2 stations nearby: Earl's Court station a short 5-minute walk away and West Kensington Station a 10-minute walk.

This apartment features high ceilings, a contemporary interior, while retaining its original Victorian charm. Boasts two generously sized bedrooms, including a modern en-suite in the master bedroom, a spacious lounge.

This half-basement flat is a unique and comfortable living space that offers both a cozy atmosphere and plenty of natural light and ventilation.

The recent contemporary renovations have revitalised the two bathrooms, infusing them with a modern aesthetic and luxurious finishes. Don't miss out on the chance to embrace the best of city living with this exceptional property.



Nevern Mansion Earl's Court SW5 9TL



- Long Lease 986 years remaining , Share of Freehold
- EPC rate C
- Excellent condition
- High ceiling
- 2 generously sized bedrooms
- 2 contemporary recent renovated bathrooms
- Victorian features
- Grand common lobby with residents' private access
- Lift
- Unfurnished



FYFFE PROPERTY LTD
EST. 2015
MEMBER OF THE
NPS KCB



020 8087 3328

www.fyffeproperty.com

info@fyffeproperty.com

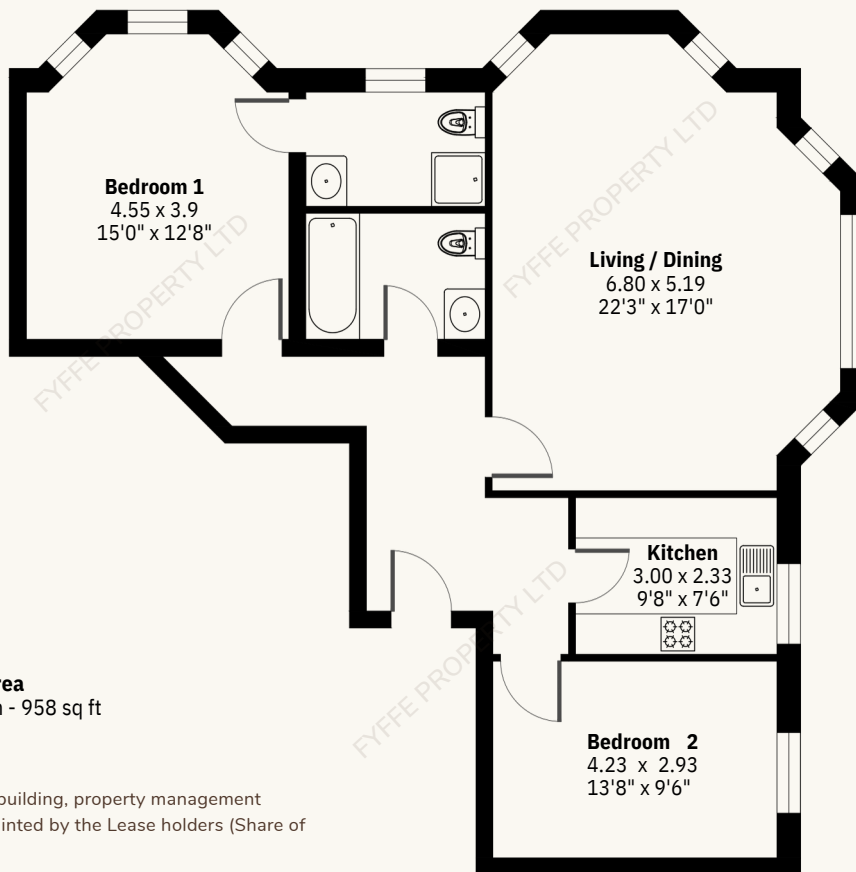

Floor Area

Approx 89.00 sq m - 958 sq ft

- Very well-maintained building, property management company directly appointed by the Lease holders (Share of Freehold)
- Service charge March to Sep 2023 : £1,800 / 6 months



020 8087 3328



www.fyffeproperty.com



info@fyffeproperty.com