



INCORPORATING
Waterford's
Residential Sales & Lettings

5 Primrose Drive, Bisley, GU24 9RU

£360,000

5 Primrose Drive, Bisley, GU24 9RU

Beautiful Two-Bedroom Home in a Peaceful Cul-de-Sac

Nestled in a quiet cul-de-sac within the sought-after Flowers Development in Bisley, this stunning two-bedroom home offers both comfort and convenience.

Step inside to a spacious living/dining area, creating a warm and inviting atmosphere. The front-aspect kitchen is well-equipped with modern appliances, generous counter space, and ample storage. A convenient ground-floor WC completes the layout.

Upstairs, you'll find two well-proportioned bedrooms, both featuring built-in wardrobes. The stylish three-piece bathroom, finished in crisp white, includes a shower over the bath.

Outside, the front garden is laid to lawn, perfect for entertaining. Ample residents' parking is also available.

Offered to the market with no onward chain this delightful home is ideal for those seeking a peaceful setting with great amenities nearby. Prompt viewings are encouraged and can be booked by calling Waterfords Estate Agents.



Floor Plan

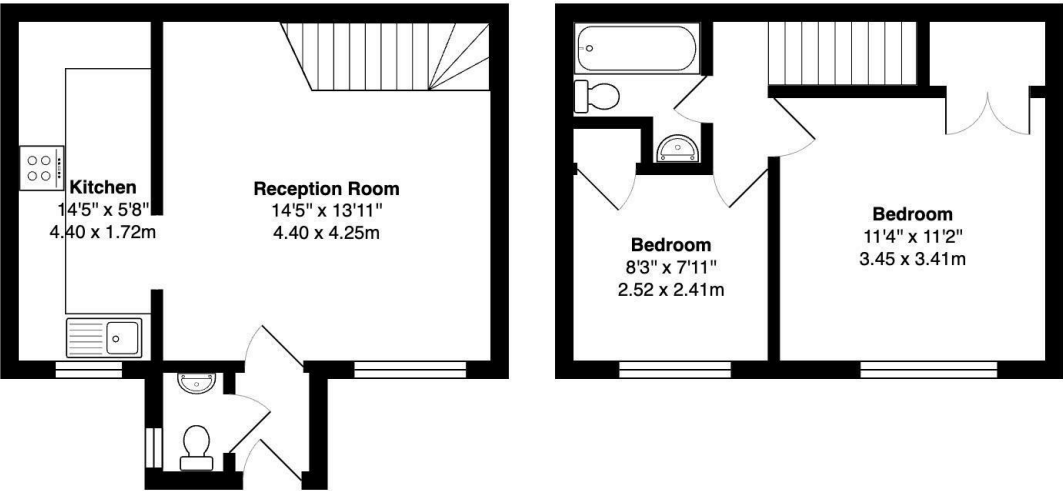

Primrose Drive, Bisley, GU24 9RU

Total Area: 610 ft² ... 56.7 m²

All measurements are approximate and for display purposes only



Features

- Prime Location – Situated in a quiet cul-de-sac within the sought-after Flowers Development in Bisley.
- Modern Kitchen – Front-aspect kitchen with appliances, ample counter space, and storage.
- Bathroom – White three-piece suite with a shower over the bath.
- No Onward Chain
- Spacious Living Area – Open-plan living/dining room with a seamless flow into the kitchen.
- Two Well-Proportioned Bedrooms – Both featuring built-in wardrobes for added convenience.
- Outdoor & Parking – Front garden and ample residents' parking.

Aspen Estate Agents incorporating Waterfords

32 High Street
Chobham
Surrey
GU24 8AA
01276 858 589
chobham@waterfords.co.uk



Tenure - Freehold Council Tax Band - C



INCORPORATING
Waterfords
Residential Sales & Lettings