

## Osbourne Road, Dartford, DA2

Guide Price £210,000

2 1 1



Please Quote Ref TH0310 For All Enquiries - Well presented two bedroom ground floor apartment (643 Sq.Ft) with residents parking, ideally located in a popular modern development on the outskirts of Dartford, within easy reach of transport links and the M25/A2. The property has been beautifully appointed, offering bright, well planned accommodation with modern interiors and quality finish throughout. Features include a wonderful dual aspect reception room, well equipped kitchen, modern bathroom, electric heating, ample inbuilt storage, and quality floor coverings.



## Key Features

- Please Quote Ref TH0310 For All Enquiries
- Popular Development on the Outskirts of Dartford
- Bright and Spacious Dual Aspect Reception Room
- Modern Bathroom
- Easy Access to Dartford Town Centre, M25 and A2
- Well Presented Two Bedroom Ground Floor Apartment (643 Sq.Ft)
- Modern Interiors
- Separate Well Equipped Kitchen
- Residents Parking
- Short Drive to Bluewater Shopping Centre

**Approximate Gross Internal Area 643 sq ft - 60 sq m**

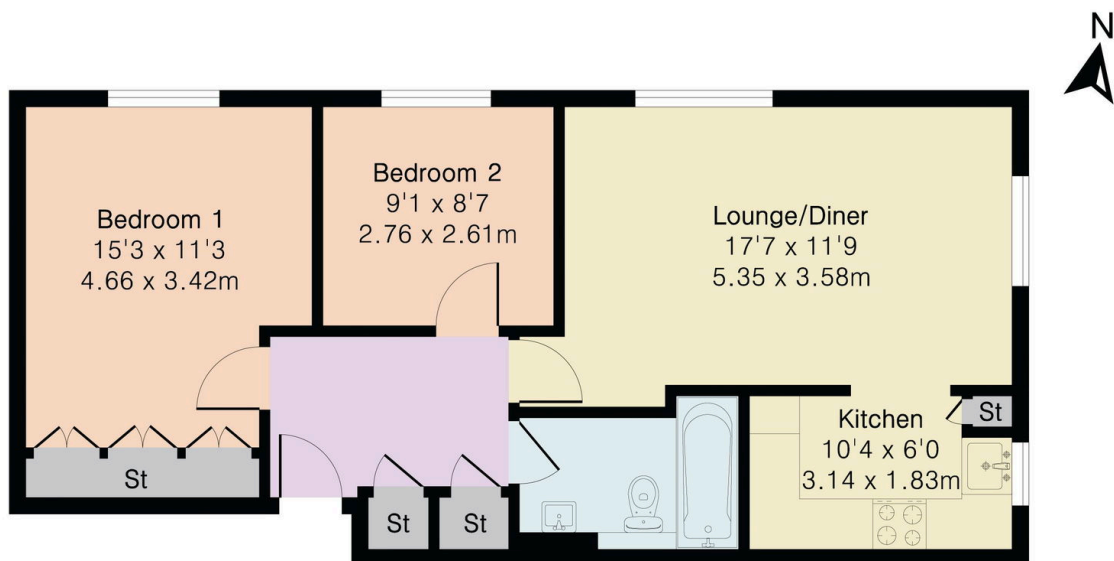

Ground Floor

