

## Rectory Road, Beckenham, BR3

Guide Price £265,000

1 1 1



Please Quote Ref TH0310 For All Enquiries - Stylishly presented one bedroom second floor flat (591 Sq.Ft) with residents parking and private garage, set within a popular development in the heart of Beckenham, just a short walk from Beckenham Junction station and amenities. The property offers bright, well planned accommodation, flooded with natural light, with modern interiors and quality finish throughout - ideal for homeowner or investor alike. Features include a beautiful reception room, well equipped kitchen, modern bathroom, electric heating, double glazing, ample inbuilt storage, and quality floor coverings.



## Key Features

- Please Quote Ref TH0310 For All Enquiries
- Central Beckenham Location
- Bright and Spacious Reception Room
- Modern Bathroom
- Short Walk to Beckenham Junction Station and Tramlink
- Beautifully Presented One Bedroom Second Floor Flat (591 Sq.Ft)
- Stylish Interiors and Neutral Finish
- Well Equipped High Gloss Kitchen
- Residents Parking and Private Garage
- Close to Town Centre Amenities

### Rectory Road, BR3

Approximate Gross Internal Area = 54.91 sq m / 591 sq ft

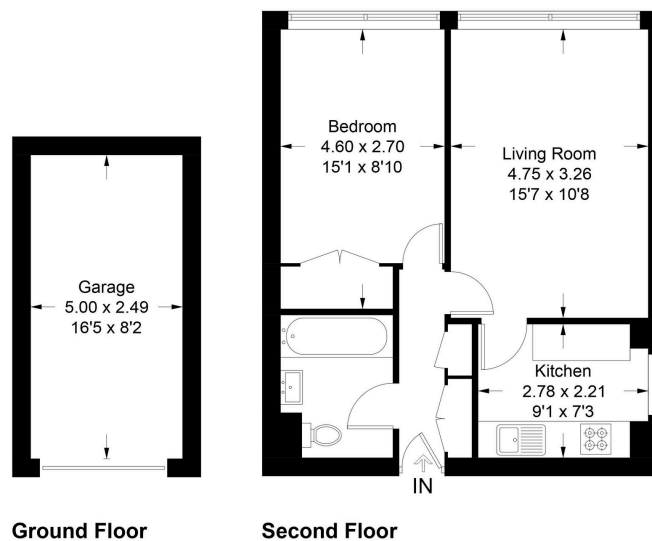

Illustration for identification purposes only, measurements are approximate, not to scale. Fourlabs.co © (ID1204508)

