

Dunedin Way, Hayes, UB4 9LQ
£500,000

3 1 1 D



Dunedin Way, Hayes, UB4 9LQ

£500,000

- Three Bedrooms
- Front + Rear Gardens
- Chain Free
- Good Transport Links
- Freehold
- Downstairs W.C
- Close To Shops
- Schools Nearby

Description

This house offers a perfect blend of comfort and convenience for family living, spanning an impressive 1,041 Sq Ft. The property comprises of a welcoming entrance porch, downstairs WC, a light filled reception room with a fire place, a dining area and a modern fitted kitchen.

The first floor features three generous bedrooms and a family bathroom.

A low maintenance front garden leads you to the front door. To the rear is a private garden perfect for outside dining and entertainment. Additionally, the outbuilding in the garden presents a versatile option for storage.

Situation

Dunedin Way with easy access to a variety of local amenities including Lombardy Retail Park (within walking distance) and the Uxbridge Road with its array of shops, restaurants, takeaways, and coffee shops. Transport links here provide popular bus routes, the M4/A40 road links (providing access to London and The Home Counties), Heathrow Airport reachable in 10 minutes by car. The Elizabeth Line runs from Hayes & Harlington Station being just a short drive away making the commute into Central London a breeze. A number of highly rated schools including Yeading junior school and Barnhill community high school also within close proximity.



Floor Plans

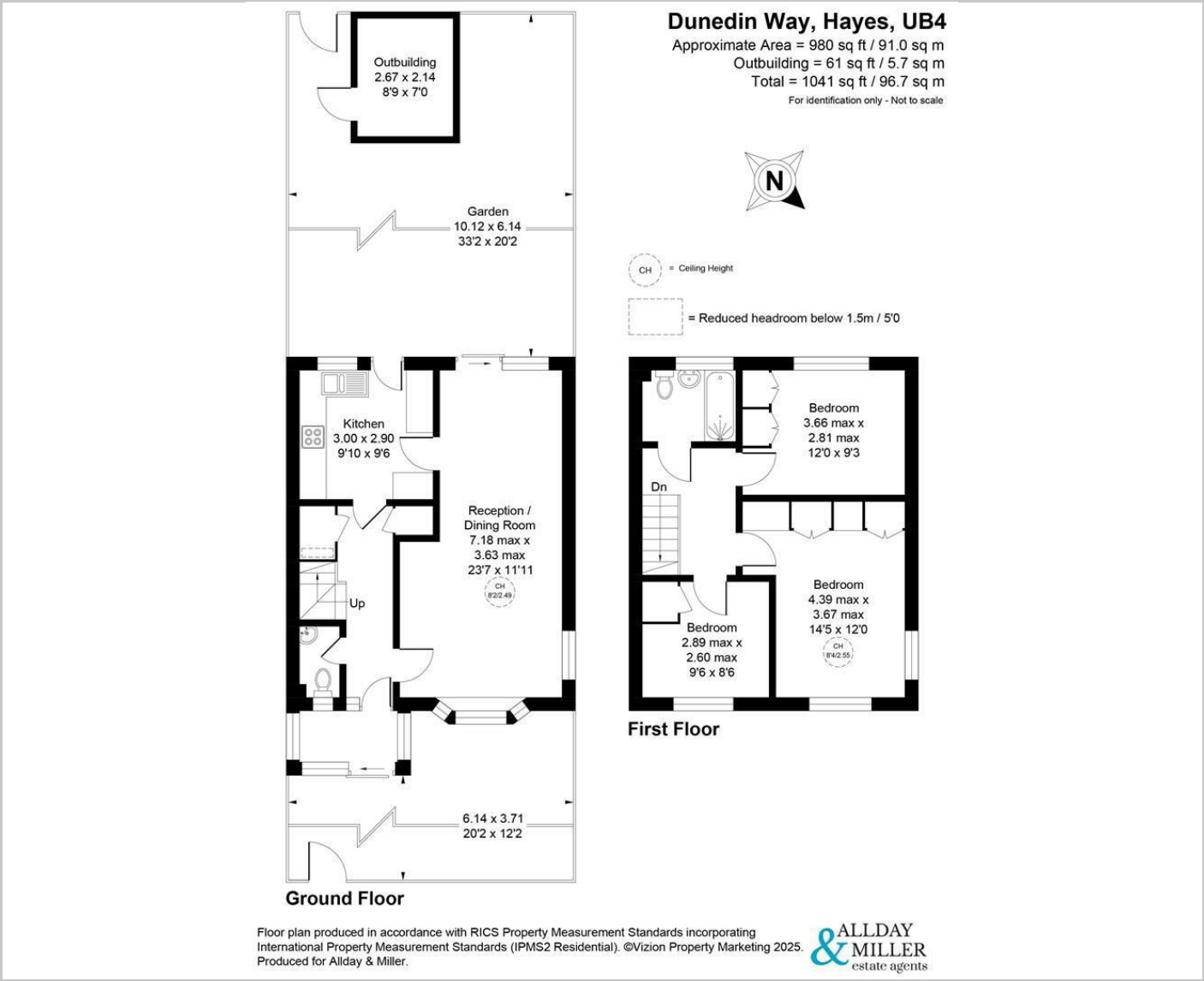

Area Map

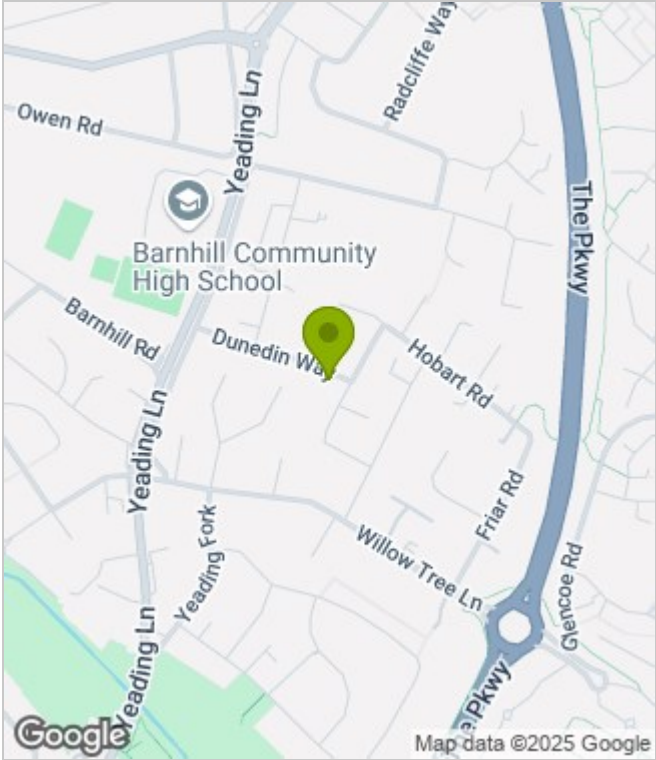

Energy Performance Graph

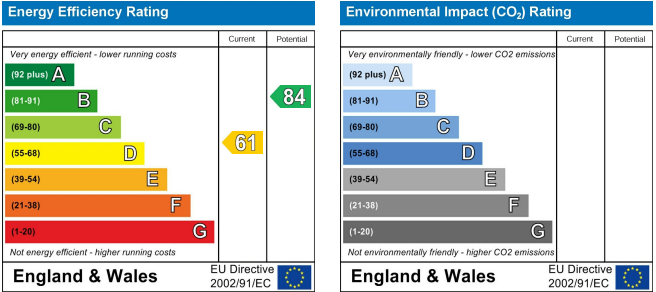

These particulars, whilst believed to be accurate are set out as a general outline only for guidance and do not constitute any part of an offer or contract. Intending purchasers should not rely on them as statements of representation of fact, but must satisfy themselves by inspection or otherwise as to their accuracy. No person in this firms employment has the authority to make or give any representation or warranty in respect of the property.