

ALLDAY  
& MILLER



Middle Way, Hayes, UB4 9LZ  
£485,000

 3  1  1  D



Middle Way, Hayes, UB4 9LZ

**£485,000**

- Three Bedrooms
- Downstairs WC
- Conservatory
- Good Transport Links
- Freehold
- Gated Off Street Parking
- Walking Distance To Shops
- Easy Reach To A Elizabeth Line Station

## Description

Presented to the market a three bedroom family home with gated off street parking, situated in North Hayes.

Versatile and spacious this property consists of a welcoming entrance, generously sized reception room leading into the conservatory which gives access to the garden, fully fitted kitchen and downstairs WC to complete the ground floor.

The first floor enjoys three bedrooms(two doubles and a spacious third) and a family bathroom suite.

A low maintenance front garden leading to the front door. To the rear a secluded private garden perfect for outside dining and entertainment. To the rear gated off street parking.

## Situation

Middle Way a popular residential road in the heart of North Hayes. With easy access to a variety of local amenities including bus links, the M4/A40 road links (providing access to London and The Home Counties), Heathrow Airport, a number of local shops, restaurants and cafes. The Elizabeth Line runs from Hayes & Harlington Station being just a 11 minute drive away making the commute into central London a breeze. A number of local schools including Lake Farm Park Academy also within close proximity.



## Floor Plans

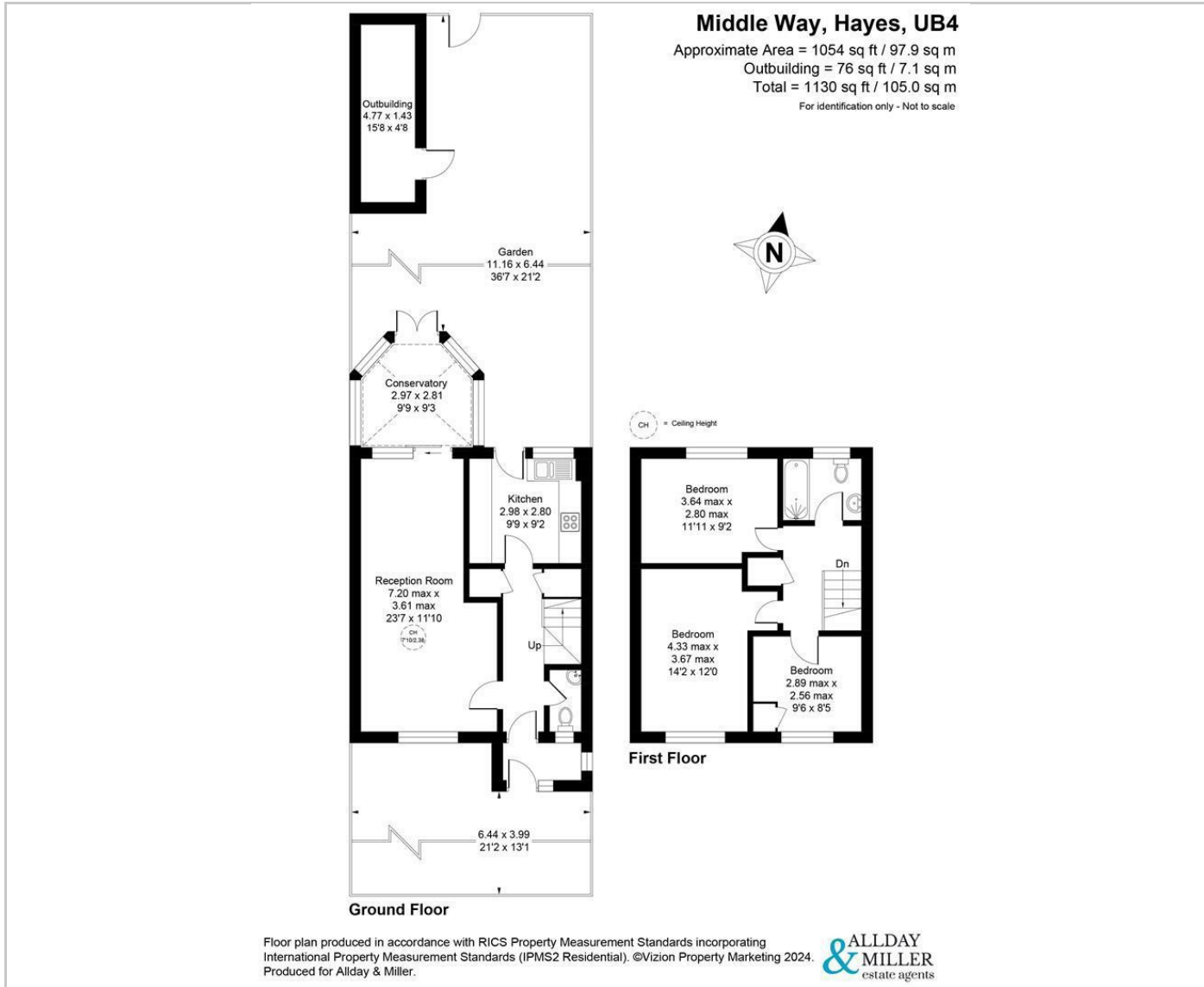

## Area Map

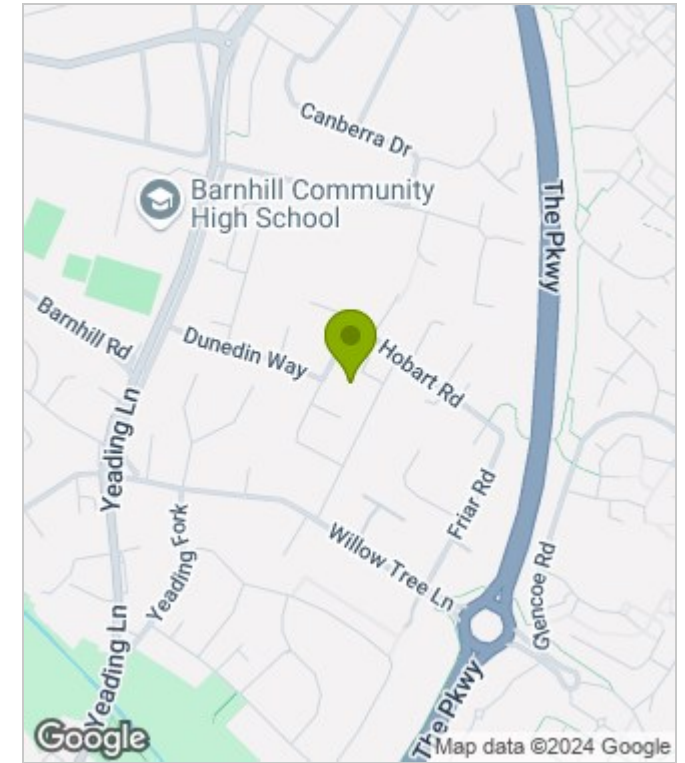

## Energy Performance Graph

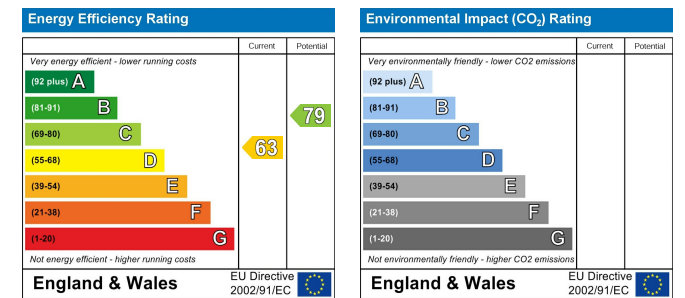

These particulars, whilst believed to be accurate are set out as a general outline only for guidance and do not constitute any part of an offer or contract. Intending purchasers should not rely on them as statements of representation of fact, but must satisfy themselves by inspection or otherwise as to their accuracy. No person in this firm's employment has the authority to make or give any representation or warranty in respect of the property.