

# BENSON

## INTERNATIONAL

ACQUISITION | SALES | INVESTMENT



## 21 Elms Road

Harrow Weald, Harrow, HA3 6BB

Guide price £1,350,000

Situated in the sought-after location of The Elms, Harrow, this spacious and versatile detached house offers an exciting opportunity to create your dream family home.

Boasting six generously sized bedrooms and four bathrooms, this property is perfect for those seeking ample living space and the potential to extend and modernise to suit your needs.

Set on a large plot, the house offers fantastic lateral space and the opportunity to transform it into a stunning, bespoke family residence. The expansive grounds provide ample outdoor space, ideal for entertaining or relaxing with family.

Located in a highly desirable area, this home is within close proximity to several top-rated schools, including North London Collegiate, Avanti House Primary School, Salvatorian College, and Sacred Heart, making it an ideal choice for families.

The property is also well-connected, with excellent transport links and bus routes to nearby areas, including Stanmore and Harrow Weald, ensuring easy access to the surrounding amenities and transport hubs into London as well as the M1.

With great potential and in a prime location, this detached house offers the perfect foundation to create a truly exceptional family home.

### Viewing

Please contact our Mayfair Office on +44(0)20 7268 4892 if you wish to arrange a viewing appointment for this property or require further information.



6



4



3



5

BENSON



Floor Plan

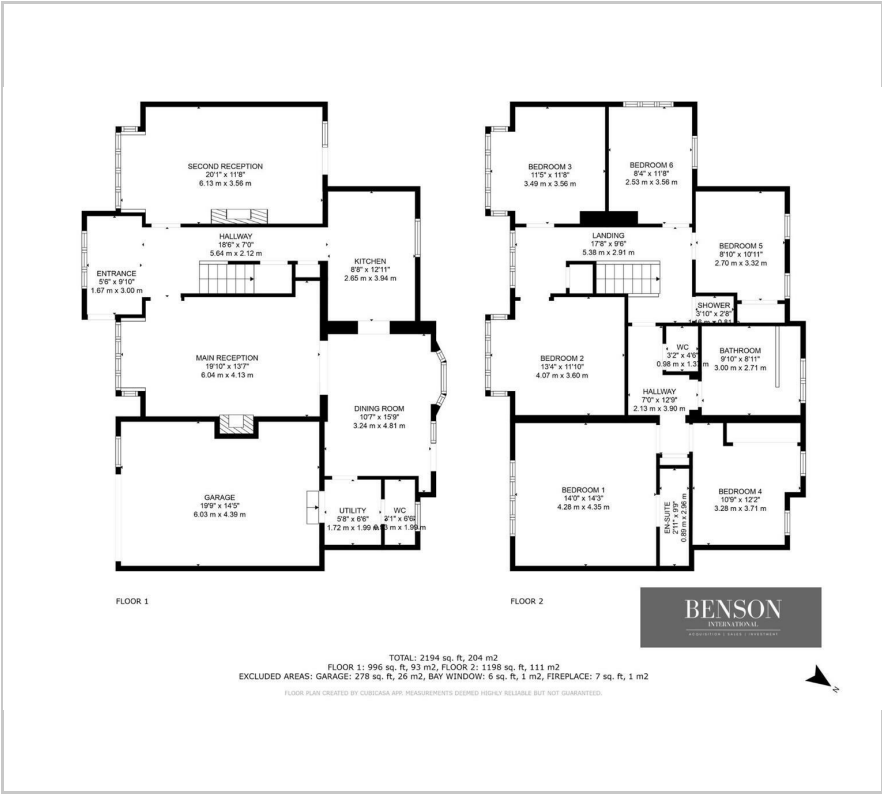

Area Map

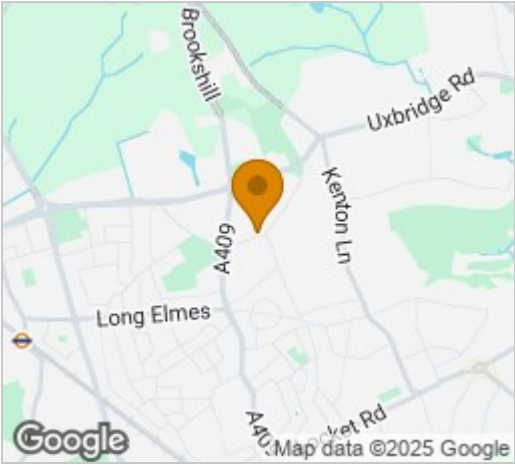

Energy Efficiency Graph

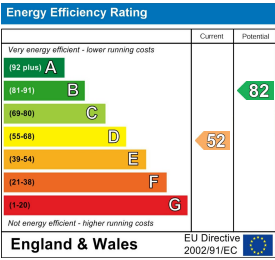

These particulars, whilst believed to be accurate are set out as a general outline only for guidance and do not constitute any part of an offer or contract. Intending purchasers should not rely on them as statements of representation of fact, but must satisfy themselves by inspection or otherwise as to their accuracy. No person in this firms employment has the authority to make or give any representation or warranty in respect of the property.