



**2 Bed  
House  
located in Thorpe  
Hesley**

Offers in the region of  
£170,000



  
**BURROWS**  
*Residential*



GROUND FLOOR  
402 sq.ft. (37.4 sq.m.) approx.

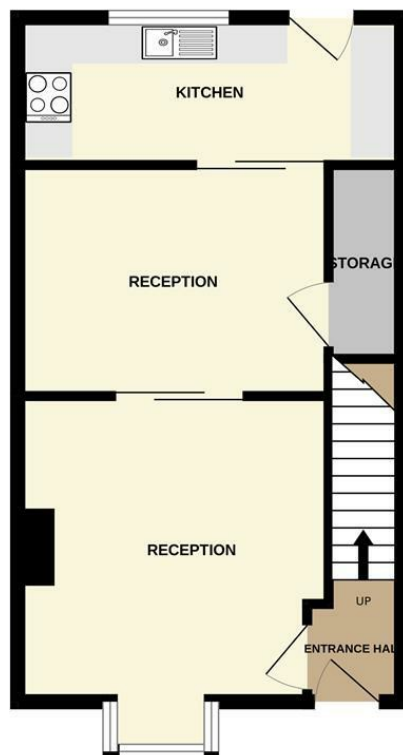

1ST FLOOR  
320 sq.ft. (29.7 sq.m.) approx.



TOTAL FLOOR AREA: 722 sq.ft. (67.1 sq.m.) approx.

Whilst every attempt has been made to ensure the accuracy of the floorplan contained here, measurements of doors, windows, rooms and any other items are approximate and no responsibility is taken for any error, omission or mis-statement. This plan is for illustrative purposes only and should be used as such by any prospective purchaser. The services, systems and appliances shown have not been tested and no guarantee as to their operability or efficiency can be given.  
Made with Metroplex ©2025

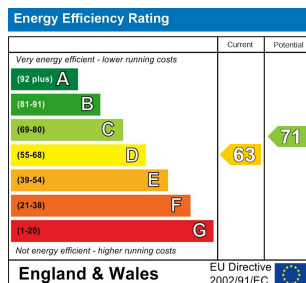

## DIRECTIONS

## CONTACT

Century 2 Business Centre Dearne Lane  
Manvers  
Rotherham  
S63 5DP

E: [info@burrowsresidential.co.uk](mailto:info@burrowsresidential.co.uk)  
T: 07507 905644

