



**3 Bed
House
located in**

Offers in the region of
£150,000



BURROWS
Residential

43, The Fairway, Moorends, DN8 4NQ

DIRECTIONS

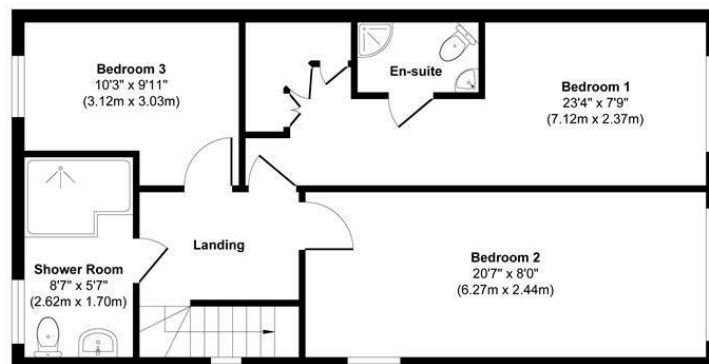

First Floor
Approximate Floor Area
603 sq. ft
(56.07 sq. m)



Ground Floor
Approximate Floor Area
603 sq. ft
(56.07 sq. m)

Approx. Gross Internal Floor Area 1206 sq. ft / 112.14 sq. m

Illustration for identification purposes only, measurements are approximate, not to scale.
Produced by Elements Property

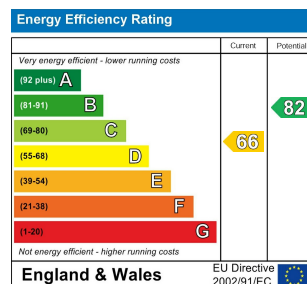

CONTACT

Century 2 Business Centre Dearne Lane
Manvers
Rotherham
S63 5DP

E: info@burrowsresidential.co.uk
T: 07507 905644

