

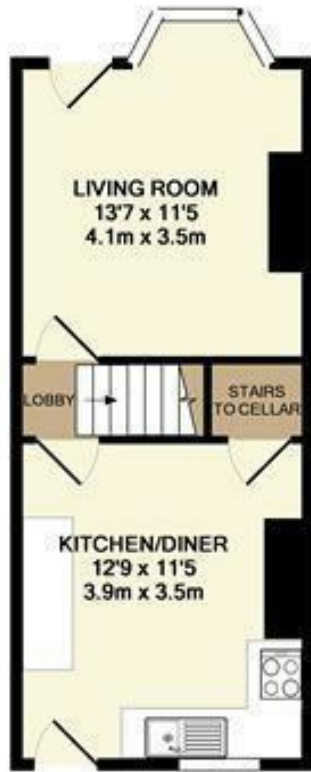

**2 Bed  
House - Mid Terrace  
located in**

Offers in the region of  
£120,000





GROUND FLOOR  
APPROX. FLOOR  
AREA 308 SQ.FT.  
(28.6 SQ.M.)



1ST FLOOR  
APPROX. FLOOR  
AREA 300 SQ.FT.  
(27.9 SQ.M.)

MEADWOHALL ROAD, ROTHERHAM, S61 2JW  
TOTAL APPROX. FLOOR AREA 608 SQ.FT. (56.5 SQ.M.)

Whilst every attempt has been made to ensure the accuracy of the floor plan contained here, measurements of doors, windows, rooms and any other items are approximate and no responsibility is taken for any error, omission, or mis-statement. This plan is for illustrative purposes only and should be used as such by any prospective purchaser. The services, systems and appliances shown have not been tested and no guarantee as to their operability or efficiency can be given.  
Made with Metropix ©2018

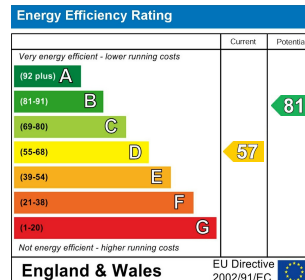

## DIRECTIONS

## CONTACT

Century 2 Business Centre Dearne Lane  
Manvers  
Rotherham  
S63 5DP

E: [info@burrowsresidential.co.uk](mailto:info@burrowsresidential.co.uk)  
T: 07507 905644

