

Canal Bank, Eccles

Offers Over £310,000

🛏️ 2 🚿 1 🛋️ 2



Freshly renovated and no onward chain! This stunning period home is set across four floors and in the heart of Monton. Blending charm, space, and modern style, this home is perfect for those who love character features but want a fresh, contemporary feel.

Key Features

- Four-Storey Victorian Home – Full of charm and character, beautifully renovated throughout.
- Dedicated Home Office – A separate room, perfect for working from home.
- Elegant Period Features – High ceilings, bay windows, and original wooden floors.
- Sought-After Monton Location – Close to the high street, canal walks, and transport links.
- No Onward Chain
- Two Spacious Bedrooms – Plus a versatile loft conversion for extra living space.
- Modern Kitchen – Stylish fitted units, wooden worktops, and integrated appliances.
- Large Basement – Offering great storage or conversion potential.
- Move-In Ready – Recently renovated to a high standard, blending classic charm with modern living.
- Front and Rear Garden

▼ Ground Floor

TOTAL AREA: 45.20 m² • LIVING AREA: 45.20 m² • ROOMS: 5

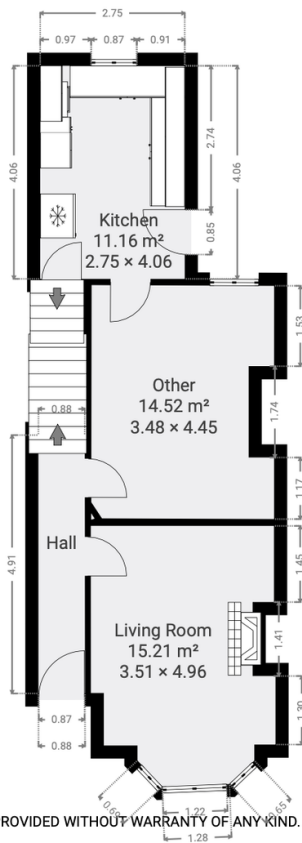

▼ 1st Floor

TOTAL AREA: 47.41 m² • LIVING AREA: 47.41 m² • ROOMS: 5

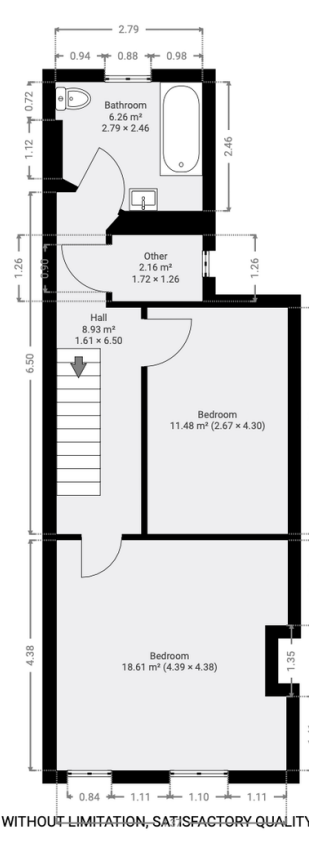

THIS FLOOR PLAN IS PROVIDED WITHOUT WARRANTY OF ANY KIND. SENSOPIA DISCLAIMS ANY WARRANTY INCLUDING, WITHOUT LIMITATION, SATISFACTORY QUALITY OR ACCURACY OF DIMENSIONS.