



MORGAN ASSOCIATES

— ESTATE & LETTINGS AGENCY —



3, Eton Lodge,  
Cheltenham GL50 2SL  
£1,050 Per Calendar Month

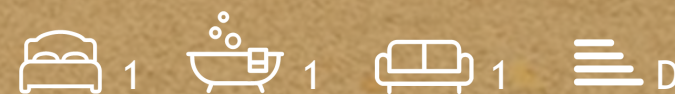



### 3, Eton Lodge,

#### Cheltenham GL50 2SL

A charming one bedroom apartment, occupying the raised ground floor of a handsome Regency villa in The Park, one of Cheltenham's most desirable residential districts. Ideally positioned within walking distance of the excellent amenities on Bath Road, this apartment offers a superb blend of period character and contemporary convenience.

The well-proportioned accommodation includes a spacious living room featuring ornate cornicing and a decorative fireplace, a fitted kitchen with appliances, a double bedroom with built-in wardrobes, and a bathroom with a shower over the bath.

Externally, the property benefits from allocated parking for one car and is warmed by gas central heating throughout.



Floor Plan

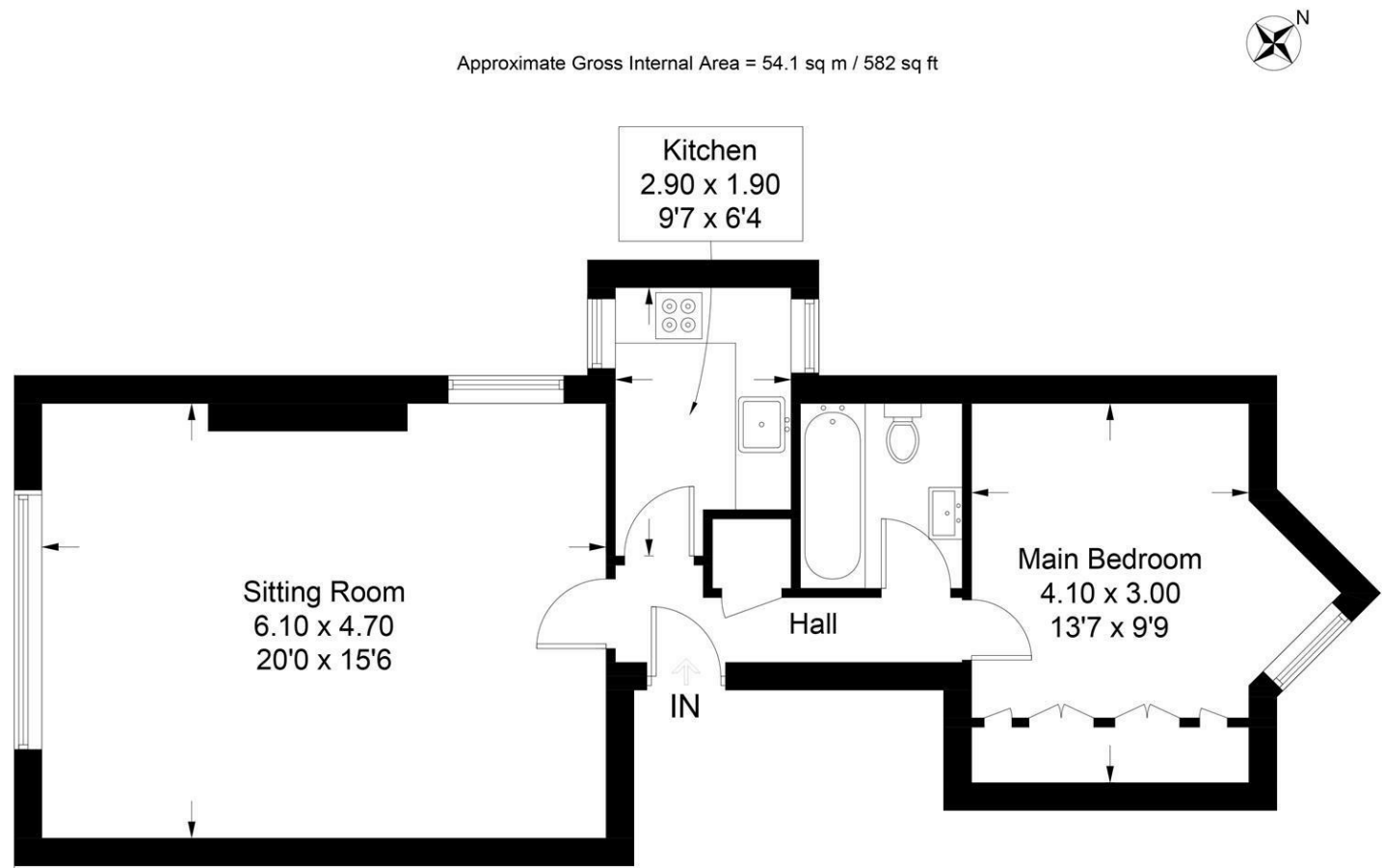
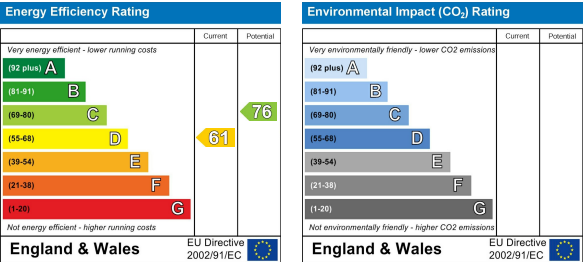

Illustration for identification purposes only, measurements are approximate, not to scale. Fourlabs.co © (ID1245481)

These particulars, whilst believed to be accurate are set out as a general outline only for guidance and do not constitute any part of an offer or contract. Intending purchasers should not rely on them as statements of representation of fact, but must satisfy themselves by inspection or otherwise as to their accuracy. No person in this firms employment has the authority to make or give any representation or warranty in respect of the property.

Energy Efficiency Graph



Area Map



Viewing

Please contact us on 01242 514 285 if you wish to arrange a viewing appointment for this property or require further information.

Rotunda Buildings Montpellier Exchange  
Cheltenham  
Gloucestershire  
GL50 1SJ

T. 01242 514 285  
E. [info@morgan-associates.co.uk](mailto:info@morgan-associates.co.uk)  
W. [www.morgan-associates.co.uk](http://www.morgan-associates.co.uk)

