

ACRES

Lettings Office: 28 Beeches Walk, Sutton Coldfield, B73 6HN
☎ 0121 312 4997 ✉ lettings@acres.co.uk

@ www.acres.co.uk



- Mid terrace family home
- Three bedrooms
- Spacious lounge
- Conservatory
- Modern fitted kitchen
- Modern family shower room
- Low maintenance rear garden
- Single garage off



EDMONTON AVENUE, BIRMINGHAM, B44 0XF - £1,175 (FROM) PCM



COUNCIL TAX : B

VIEWING: Highly recommended via Acres on 0121 312 4997

Energy Efficiency Rating		
	Current	Potential
Very energy efficient - lower running costs		
(92 plus) A		90
(81-91) B		
(69-80) C	77	
(55-68) D		
(39-54) E		
(21-38) F		
(1-20) G		
Not energy efficient - higher running costs		
England & Wales		EU Directive 2002/91/EC



76 Edmonton Avenue, Birmingham, B44 0XF

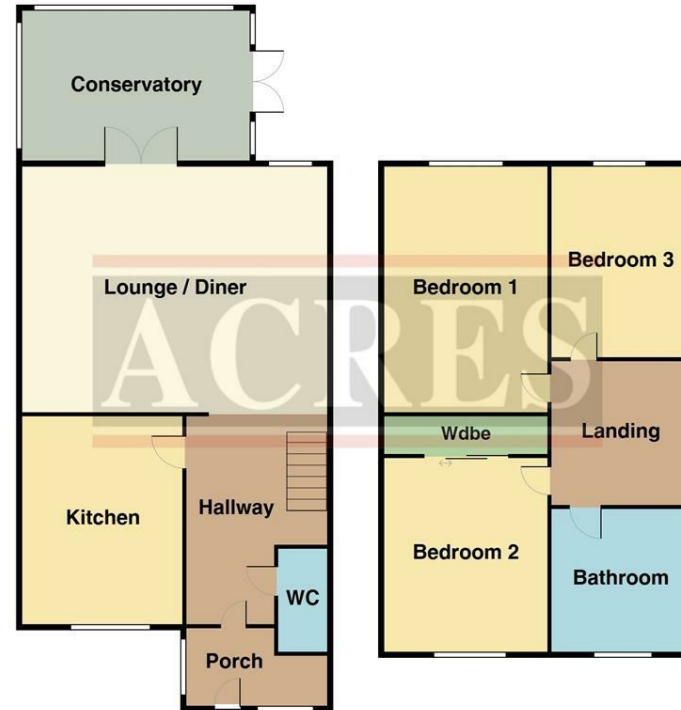

THIS PLAN IS NOT TO SCALE AND IS GIVEN TO PROVIDE A GENERAL GUIDE. IT MERELY INDICATES APPROXIMATE RELATIONSHIP OF ONE ROOM TO ANOTHER.

Every care has been taken with the preparation of these Particulars but complete accuracy cannot be guaranteed. If there is any point, which is of particular importance to you, please obtain professional confirmation; alternatively, we will be pleased to check the information for you. We have not tested any apparatus, equipment, fixture, fittings or service and so cannot verify they are in working order, fit for their purpose, or within ownership of the sellers. All Dimensions are approximate. Items shown in photographs are NOT included unless specifically mentioned in writing within the sales particulars. They may however be available by separate negotiation.