



The Thatches Holiday Village, Modbury

Guide Price £110,000

🛏 2 🍽 2 🛋 1



- Two-bedroom detached lodge in The Thatches Holiday Village
- Spacious lounge with separate dining room
- Fully fitted separate kitchen
- Modern family bathroom
- Excellent on-site facilities including indoor pool, gym, sauna, steam room, and launderette
- Set within 16 acres of communal woodland and landscaped gardens
- Dining room opens onto raised decking area
- Master bedroom with en suite shower room
- Generous private garden space
- Family-friendly amenities including cinema, games room, outdoor play areas, and EV charging points



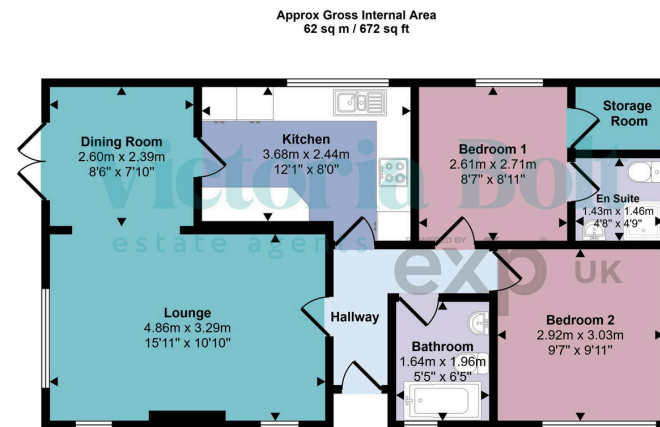

Floorplan

This floorplan is only for illustrative purposes and is not to scale. Measurements of rooms, doors, windows, and any items are approximate and no responsibility is taken for any error, omission or mis-statement. Icons of items such as bathroom suites are representations only and may not look like the real items. Made with Made Snappy 360.

This charming two-bedroom detached holiday lodge is set within the sought-after Thatches Holiday Village in Modbury, Ivybridge. Surrounded by 16 acres of communal woodland and gardens, it offers a spacious private garden, raised decking area, separate kitchen, lounge, dining room, two bedrooms (one with en suite), and a family bathroom. Residents enjoy exclusive access to fantastic on-site facilities including an indoor swimming pool, gym, sauna, steam room, launderette, cinema, games room, outdoor play areas, and electric vehicle charging points. An ideal holiday home or peaceful countryside retreat.