



Western Row, Hemerdon

Guide Price £375,000

3 2 1



- Two/three double bedroom character cottage
- Modern kitchen/diner
- Modern shower room
- Solar panels on the roof
- On street parking
- Wooden beams & woodburner in the lounge
- Utility room & downstairs WC
- Extensive low-maintenance rear garden
- Workshop and greenhouse
- Peaceful village location



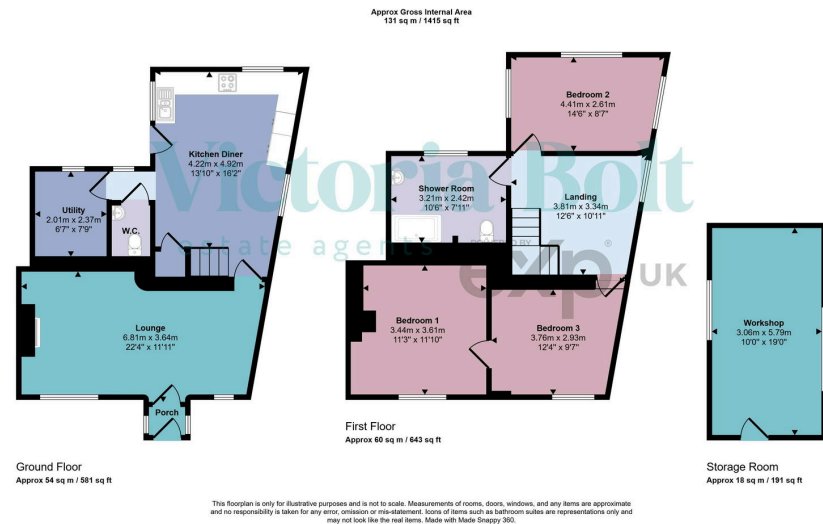

Set on a desirable corner plot, this two/three-bedroom cottage blends traditional charm with modern convenience. The spacious lounge features wooden beams, adding character. At the same time, the contemporary kitchen/diner provides ample space for entertaining alongside a utility room and downstairs W.C. Upstairs, there are three well-proportioned bedrooms and a modern shower room. Energy-efficient solar panels are also installed on the roof.

The property boasts an extensive, low-maintenance rear garden with great potential for transformation, plus a separate workshop for added versatility. Located in a peaceful village with easy access to Plymouth and local amenities, this home is perfect for those seeking a character property with plenty of space. Viewing highly recommended!

