



Victoria Bolt
estate agents POWERED BY **exp** UK

Merafield Road, Plympton

Guide Price £375,000

🛏 3 🚿 2 🛋 2



- Detached three/four bedroom house
- Split-level rear garden with a patio, decking, and artificial grass
- Separate dining room, this could also be used as a study, playroom or further bedroom
- Back built outbuilding
- Integral garage & driveway
- Modern kitchen with direct access to the garden
- Ground floor bathroom & ensuite to master bedroom
- Side access to rear garden
- Close to local schools, parks, and amenities, with great transport links to Plymouth city centre and beyond
- Panoramic views over Plympton towards Dartmoor



This well-presented detached home offers spacious living with a garage, driveway, and low-maintenance garden. The landscaped rear garden features a large patio, raised decking, an artificial grass area, and a brick-built outbuilding.

The ground floor includes a bright lounge, dining room, modern kitchen with garden access, a bathroom, and a double bedroom. Upstairs are two more spacious bedrooms, including the master with an en-suite.

A fantastic opportunity for families or professionals—viewing is highly recommended!

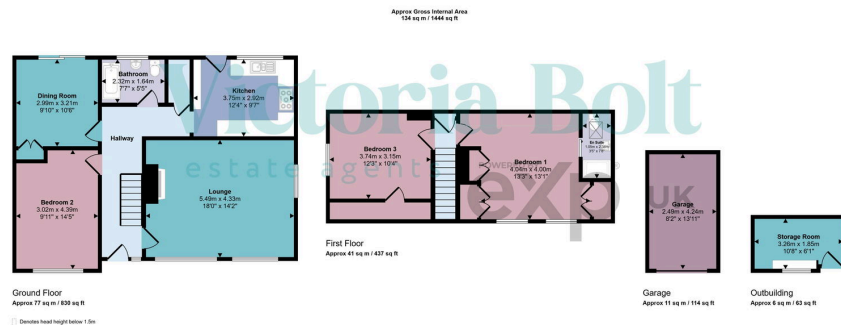

This diagram is only for illustrative purposes and is not to scale. Measurements of rooms, doors, windows, and any items are approximate and no responsibility is taken for any error, omission or mis-statement. Views of items such as bathroom suites are representations only and may not look like the real items. Views with Mobile Strategy 360.

