



Victoria Bolt
estate agents POWERED BY exp[®] UK

Bond Street, Cornwood

Guide Price £210,000

2 1 1



- Chain-Free & Ready to Move In
- Spacious lounge with a beamed ceiling and a stunning stone inglenook fireplace with a wood burning stove
- Enclosed rear garden with storage, plus additional garden areas at the front and side in a stunning semi-rural setting with easy access to local amenities
- Charming two-bedroom end-of-terrace cottage
- Well-fitted kitchen with direct access to outdoor space
- Shower room with modern fixtures and an electric shower
- Double-glazed windows
- Full of character and charm



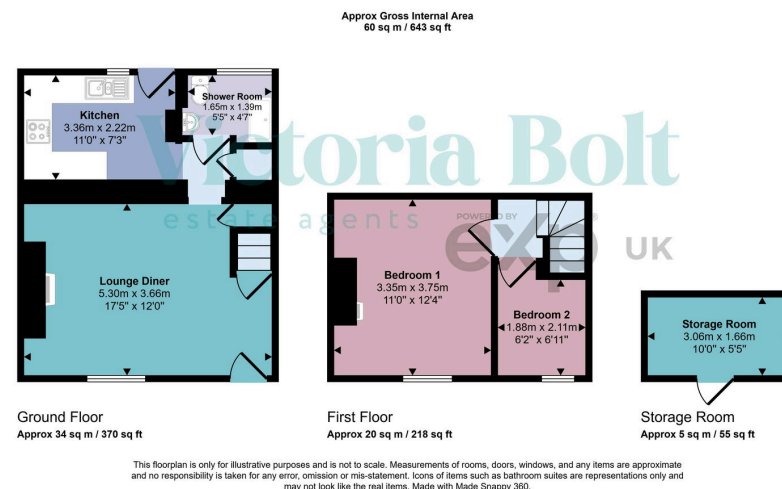

NO ONWARD CHAIN. This delightful former worker's cottage for the Blachford Estate is full of character, featuring substantial stone walls, original fireplaces, and a beamed ceiling. The spacious lounge boasts a stunning inglenook fireplace with a wood-burning stove, while the kitchen opens to an enclosed rear garden with storage. The property includes two charming bedrooms and a shower room. Outside is an old Piggery, which is ideal for outdoor storage items including kayaks and bikes. Situated in the heart of the village near local amenities, this chain-free home is perfect for first-time buyers, retirees, or investors.

