



Victoria Bolt
estate agents POWERED BY **exp** UK

Libra Avenue, Sherford

Offers Over £300,000

3 3 1



- Terraced family home arranged over three floors
- Two years remaining on the NHBC
- Good size lounge
- Study/fourth bedroom/dining room
- Level garden, garage and parking
- Built by Bovis Homes in 2017
- Flexible accommodation
- Three or four bedrooms
- Kitchen/diner with integrated appliances
- Ensuite to master bedroom, downstairs WC and family bathroom



This mock 'Georgian' terraced house was built by Bovis Homes in 2017 and is situated in the Heart of Sherford. The ground floor features a stylish kitchen/diner, a fourth bedroom or home office, and a convenient WC. The first floor has a spacious lounge and a double bedroom. The top floor includes the master bedroom with en-suite, a further double bedroom, and a family bathroom.

Outside, the property benefits from a private, level garden, driveway parking, and a garage. The property benefits from 2 years remaining on the NHBC warranty. Located in Sherford, it's close to excellent amenities, schools, and major transport links.

Book your viewing today!

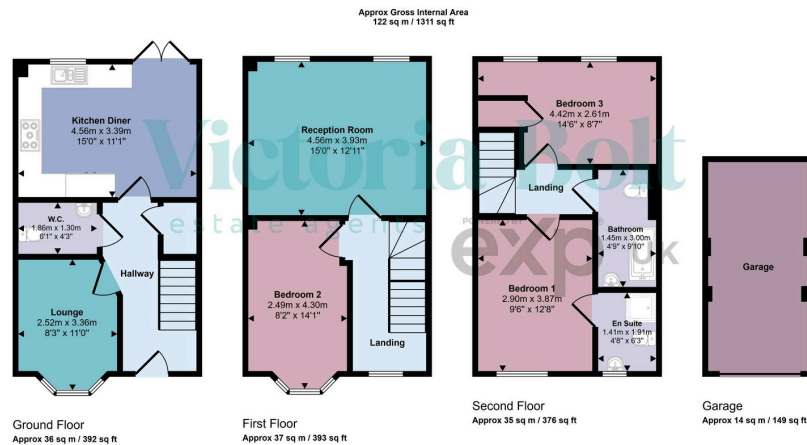

This floorplan is only for illustrative purposes and is not to scale. Measurements of rooms, doors, windows, and any items are approximate and no responsibility is taken for any error, omission or mis-statement. Icons of items such as bathroom suites are representations only and may not look like the real items. Made with Made Snappy 360.

