

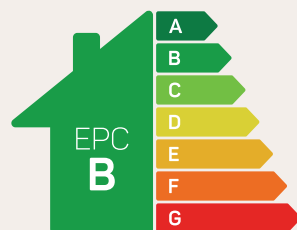

# The Cheltenham

4 bed detached

A stylish detached home featuring traditional features and modern, open-plan living spaces.



Predicted EPC rating

[anwylhomes.co.uk](http://anwylhomes.co.uk)

## Ground Floor Plan

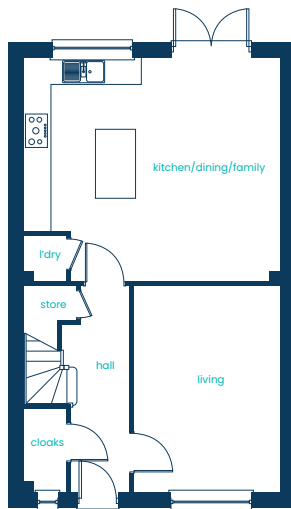

Room	Metric	Imperial
Kitchen/Dining/Family	5.76m x 5.03m	18'11" x 16'6"
Living Room	3.25m x 4.63m	10'8" x 15'2"
Cloaks	0.95m x 1.88m	3'1" x 6'2"
Laundry	0.95m x 1.03m	3'1" x 3'5"

## First Floor Plan

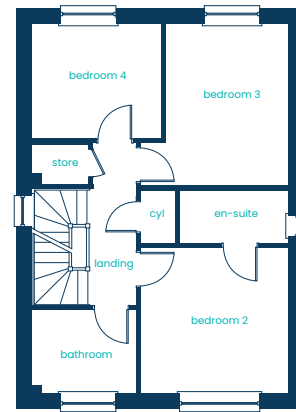

Room	Metric	Imperial
Bedroom 2	3.33m x 3.29m	10'11" x 10'10"
En-suite 2	2.44m x 1.20m	8'0" x 3'11"
Bedroom 3	3.33m x 3.65m	10'11" x 12'0"
Bedroom 4	2.93m x 2.60m	9'7" x 8'6"
Bathroom	2.34m x 1.88m	7'8" x 6'2"

## Second Floor Plan

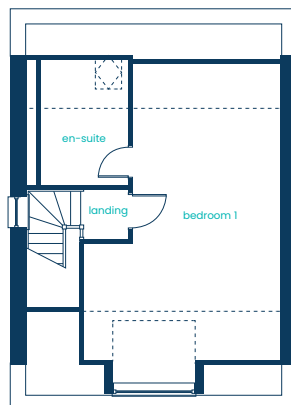

Room	Metric	Imperial
Bedroom 1	4.43m x 7.27m	14'7" x 23'10"
En-suite 1	2.00m x 2.85m	6'7" x 9'4"

# The Cheltenham

## 4 bed detached

Anwyl Homes is a registered developer with the NHQB. The images on this literature are computer-generated. Specific plots may be 'handed' (mirrored), detached/semi-detached, elevation treatment/roof materials may vary, and any garages may be single or double. Room sizes are approximate, dimensions are taken from the longest room point and are for guidance only. Kitchen and bathroom layouts are indicative. These plans are correct at the time of creation but may be subject to change during construction. Please speak to your Homes Adviser for more details. The Cheltenham 09/01/25.



[anwylhomes.co.uk](https://anwylhomes.co.uk)