



**1 Bed
Apartment
located in**

£1,600 Per Month



ACEN
PROPERTIES

SECOND FLOOR 491 sq.ft. (45.6 sq.m.) approx.

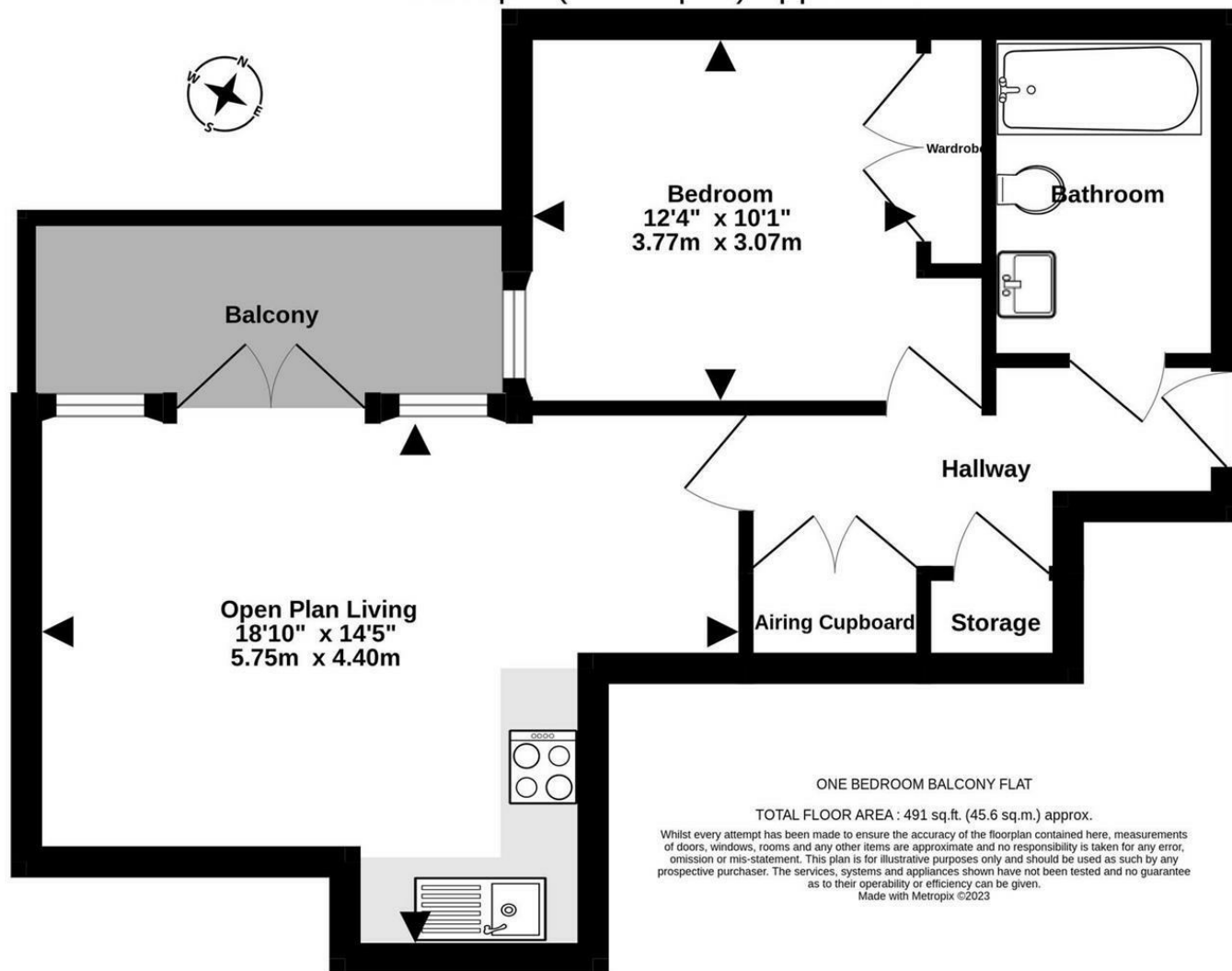

ONE BEDROOM BALCONY FLAT

TOTAL FLOOR AREA : 491 sq.ft. (45.6 sq.m.) approx.

Whilst every attempt has been made to ensure the accuracy of the floorplan contained here, measurements of doors, windows, rooms and any other items are approximate and no responsibility is taken for any error, omission or mis-statement. This plan is for illustrative purposes only and should be used as such by any prospective purchaser. The services, systems and appliances shown have not been tested and no guarantee as to their operability or efficiency can be given.

Made with Metropix ©2023

Energy Efficiency Rating		
	Current	Potential
Very energy efficient - lower running costs		
(92 plus) A		
(81-91) B	83	83
(69-80) C		
(55-68) D		
(39-54) E		
(21-38) F		
(1-20) G		
Not energy efficient - higher running costs		
England & Wales	EU Directive 2002/91/EC	

DIRECTIONS

CONTACT

Newminster House 27-28 Baldwin Street
Bristol
BS1 1LT

E: hello@acenproperties.co.uk
T: 01173634411

