



Powderham Court Powderham Terrace, Teignmouth

Teignmouth

Guide Price £225,000



# Powderham Court, Powderham Terrace

Teignmouth

Wonderful opportunity to acquire a period feature, One bedroom seafront apartment, located in the popular Powderham Court premises. With level access from the seafront, you enter into a private shared communal garden leading to the secured entrance of the property. Accommodation comprising, large entrance hallway with easy flow well configured living accommodation to spacious Reception Room, Kitchen, Bathroom and Bedroom with balcony. Allocated parking for one vehicle and storage. Breath-taking views surround this property for you to enjoy, combined with the easy access to all of the local amenities.

Accommodation comprising, large entrance hallway with easy flow well configured living accommodation to spacious Reception Room, Kitchen, Bathroom and Bedroom with balcony. Allocated parking for one vehicle and storage. Breath-taking views surround this property for you to enjoy, combined with the easy access to all of the local amenities.







## Powderham Court , Powderham Terrace

Teignmouth

Council Tax band: B

Tenure: Leasehold

- Ground floor sea front apartment with breathtaking views
- Large reception room containing all the original period features with floor to ceiling sash windows opening out to seafront vista
- Bedroom with access to balcony terrace
- Security entrance into the property
- Communal patio area soaking up the seafront views and beyond
- Allocated parking with storage area
- Level access, close to all local amenities
- Pets allowed subject to permission
- Investment opportunity 999 years lease







### Communal Garden

Balcony - looking out to sea and views of the Ness

Front Garden - soaking up the fresh air and the wonderful views

### Allocated parking

1 Parking Space - this parking space is around the back of the property underneath.



# Powderham Court, Powderham Terrace, Teignmouth, TQ14

Approximate Area = 619 sq ft / 57.5 sq m

For identification only - Not to scale

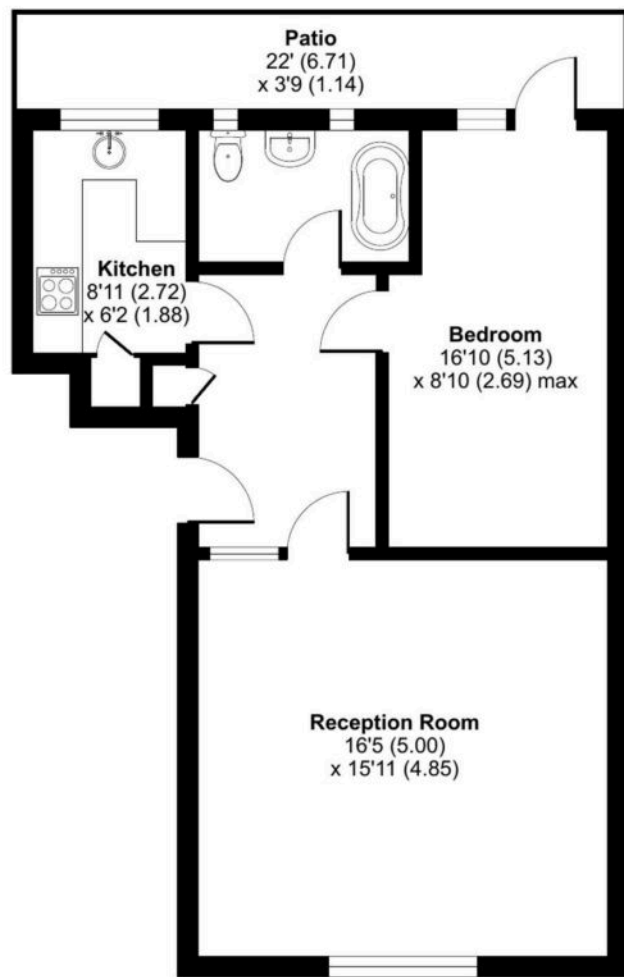

**GROUND FLOOR**



**Certified  
Property  
Measurer**

Floor plan produced in accordance with RICS Property Measurement Standards incorporating International Property Measurement Standards (IPMS2 Residential). © nchecon 2024. Produced for NXMOVE Group Ltd (Nexmove). REF: 1078474





**Nexmove**

Riviera Buildings, 3 Den Road, Devon - TQ14 8AJ

01626 681972 • [sales@nexmove.co.uk](mailto:sales@nexmove.co.uk) • [www.nexmove.co.uk/](http://www.nexmove.co.uk/)