





### 3 Uplands House Four Ashes Road, Cryers Hill

£325,000

2 1 1



### Property Description:

*This beautifully presented two-bedroom apartment forms part of an exclusive development set within the natural woodland surroundings of South Buckinghamshire. Completed just four years ago, the home combines a contemporary specification with an unrivalled sense of peace, privacy and connection to nature - a standout opportunity for those seeking something special.*

*The apartment enjoys a bright and inviting layout, with a modern kitchen offering integrated appliances, excellent storage and sleek finishes that flow seamlessly into the open-plan living space. From here, doors open to a private balcony overlooking the woodland - the perfect spot to enjoy morning coffee, summer evenings, or simply the calming sound of nature.*

*Both bedrooms benefit from generous natural light and attractive views, with the second bedroom offering direct access to a separate balcony of its own. The main bathroom has been finished to a high standard with Italian marble tiles throughout.*

*With its elevated outlook, modern finish and a calming sense of space throughout, this apartment is ideal for professional buyers, downsizers or those wanting a low-maintenance lock-up-and-leave home just moments from beautiful countryside walks.*

### The Development:

*Uplands House is a remarkable and imaginative conversion of a historic residence originally dating back to 1859. Redesigned into a selection of exquisite apartments and maisonettes, this gated community offers a unique blend of contemporary refinement and heritage charm.*

*The development provides allocated parking, CCTV security and meticulously maintained grounds that create a boutique, retreat-style environment. Residents frequently comment on the tranquil feel from the moment they enter the site - a sense of escape rarely found this close to town amenities and transport links.*

### Nearby Attractions:

- High Wycombe Train Station = 2.6 miles
- Great Missenden Train Station = 4.8 miles
- Hughenden Manor National Trust = 2.3 miles
- Village shop (walk) = 0.5 miles
- Roald Dahl Museum and Great Missenden village centre = 4.7 miles
- Hazlemere Village Shops (Costa, Butchers, Chip Shop, Coop) = 1.8 miles

### What We Love:

*At Bucks Property, we have been closely involved with Uplands House since the first homes were launched, and we proudly manage the development. This gives us unrivalled insight into the history of the building, the construction quality and the care that has gone into every phase of the conversion.*

*We love the setting - surrounded by woodland at the edge of Hughenden Valley, with a feeling of privacy and calm that buyers instantly connect with. The balconies are a real highlight, creating a year-round outlook into nature that makes this apartment a particularly appealing place to call home.*





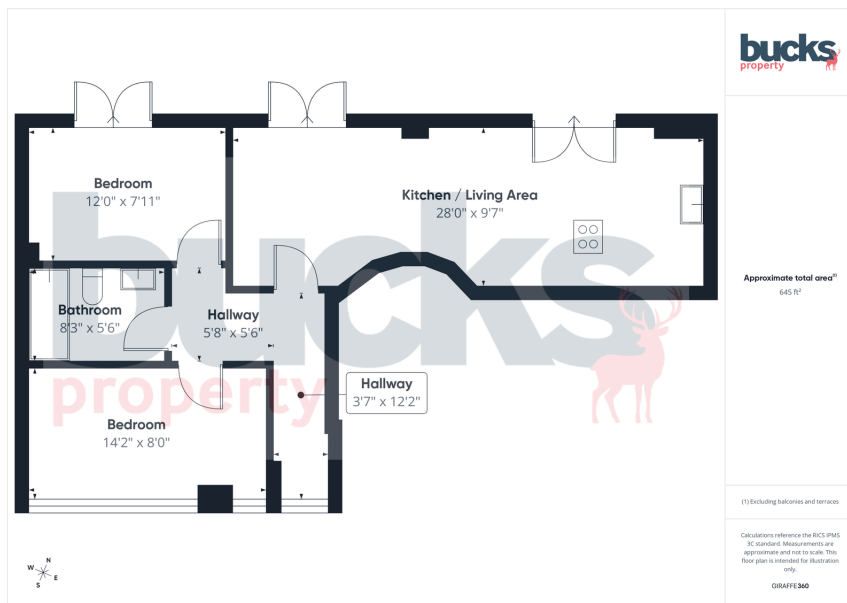

- Modern two-bedroom apartment in a peaceful woodland setting.
- Bright open-plan living space with balcony overlooking the trees.
- Contemporary kitchen with integrated appliances and excellent storage.
- Both bedrooms benefit from generous natural light and woodland views.
- Allocated parking and well maintained communal grounds.
- Built approximately four years ago and beautifully maintained.
- Direct balcony access from the living room, kitchen and second bedroom.
- Stylish main bathroom with high quality fixtures and fittings.
- Private position within a secure gated development with CCTV.
- Ideal for first-time buyers, downsizers or those seeking a lock-up-and-leave home.



[bucksproperty.co.uk](https://bucksproperty.co.uk)



1 Meadow Cottages | Little Kingshill | Great Missenden | Buckinghamshire | HP16 0DX  
t. 07780 755590 | e. [sales@bucksproperty.co.uk](mailto:sales@bucksproperty.co.uk)  
Bucks Property Services Ltd Registered Number: 14869929

rightmove

B+hive

PRS

Inventory Hive

OnTheMarket