



Saunderton Estate, 51 The Residence, Wycombe Road, Saunderton

£250,000

1 1 1



Property Description:

Big on space, bright on vibe. This oversized 710 SQFT one-bedroom apartment on the second floor of a sleek, Art-Deco inspired development is perfect for first-time buyers or professionals craving more room to breathe. With generous proportions, smart design, and glowing natural light, it delivers on style and space.

Accessed via lift or stairs from the rear of the building, this top-floor apartment sits in a peaceful position within the development – quiet, private, and just moments from the on-site gym and beautifully kept gardens. And with no one living above you, it's all the calm and privacy you could ask for.

Inside, the open-plan layout creates an expansive living/dining space that feels light, airy, and instantly welcoming. The sleek, modern kitchen comes fully fitted with Bosch appliances – including a dishwasher, washer/dryer, fridge freezer, microwave, oven and hob – plus elegant quartz worktops and a stylish breakfast bar that's made for slow mornings or sociable evenings.

The bedroom is a true retreat – spacious, calm, and beautifully finished, with plenty of room for a king-size bed, additional furniture, or even a cosy work-from-home nook. It's a serene space designed for both rest and flexibility.

The bathroom brings hotel-level luxury home, featuring clean lines, on-trend tiling, a separate bath and a walk-in rainwater shower – ideal for both quick get-up-and-go mornings and long evening soaks.

Bonus: residents enjoy access to spacious communal gardens, a fully equipped gym (free to use), and two lifts for effortless movement throughout the building.

Overview:

Set within 8 acres of landscaped grounds, this unique development offers countryside tranquillity with city convenience. Originally built in the late 1950s to house scientists from the pharmaceutical industry, the building has been transformed into stylish, modern apartments while preserving its distinctive Art Deco heritage.

Despite its serene setting, Saunderton Station is just 0.1 miles away – offering a direct 47-minute connection to London Marylebone. Whether you're heading into the city or escaping to the hills, this location works for both.

There's even a peaceful inner courtyard perfect for al-fresco working, weekend coffee breaks, or soaking up the sun.

Nearby Highlights:

*Saunderton Station – 0.1 mile
High Wycombe – 5.2 miles
Princes Risborough – 4.1 miles
Thame – 11 miles
West Wycombe & Hell-Fire Caves – 3.1 miles
Village Pub (walking distance!) – 0.1 mile*



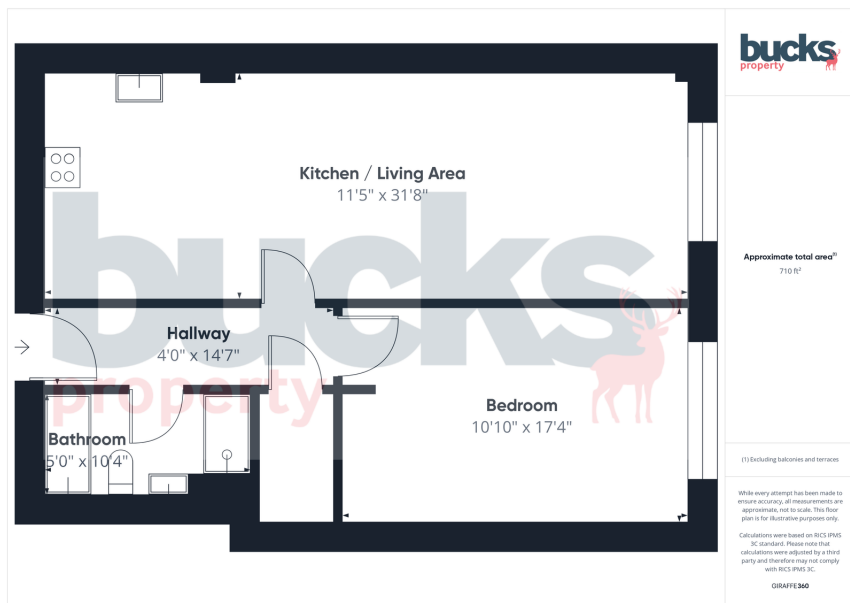

- Spacious 710 SQFT top-floor one-bedroom apartment in a stylish Art-Deco development.
- Large bedroom with plenty of space for a king-size bed and additional furniture.
- Access to beautiful communal gardens and a free on-site gym for residents.
- Allocated parking for one vehicle - ample visitors parking too!
- Set within 8 acres of landscaped grounds, offering both peaceful living and city convenience.
- High-spec kitchen with Bosch appliances, including dishwasher, washer/dryer, fridge freezer, oven, and hob.
- Luxurious bathroom featuring a separate bath and walk-in rainwater shower.
- Just 0.1 miles to Saunderton Station, with a 47-minute train journey to London Marylebone.
- Quiet, private top-floor location with no one living above you.
- Perfect for first-time buyers looking for a spacious, well-connected home.

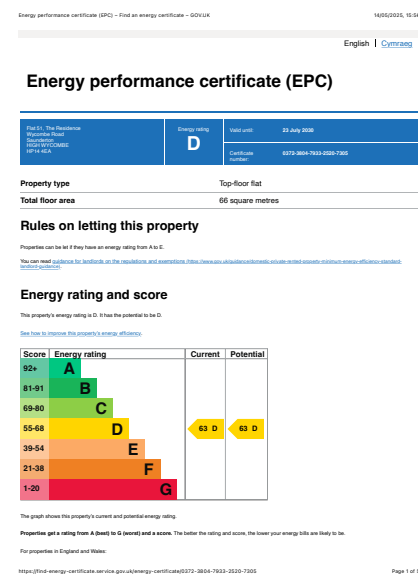

bucksproperty.co.uk

1 Meadow Cottages | Little Kingshill | Great Missenden | Buckinghamshire | HP16 0DX
t. 07780 755590 | e. sales@bucksproperty.co.uk
Bucks Property Services Ltd Registered Number: 14869929

