



39 Uplands House Four Ashes Road, Cryers Hill

Guide Price £300,000

2 1 1



Property Description:

This elegant two-bedroom ground-floor apartment is nestled in the East Wing of a prestigious South Buckinghamshire development, surrounded by serene natural beauty. Designed to an exceptional standard, its feature windows flood the space with natural light, creating a bright and inviting atmosphere.

The apartment boasts a private entrance leading into a sleek, Italian-inspired kitchen with quartz countertops, ample storage, and integrated appliances. The open-plan living area enjoys wide patio doors that frame views of the landscaped gardens, seamlessly blending indoor and outdoor living.

Both bedrooms offer picturesque garden views, with the main bedroom benefiting from large feature windows. The second bedroom, though more compact, enjoys direct access to the garden through patio doors. A beautifully designed main bathroom completes the space.

The Development:

A remarkable Grade II listed conversion, this development was originally a grand country home dating back to 1859. It features Palladian-inspired extensions by renowned architect Edward Cullinan, harmonizing historic elegance with modern luxury. Reimagined by Italian firm Area Equity—celebrated for their high-end residential and tourism projects across Europe—this unique collection of apartments and maisonettes offers a truly sophisticated living experience.

Set within a secure, gated complex with CCTV and allocated parking, the development exudes exclusivity and tranquillity. With its boutique retreat ambiance, refined luxury, and exceptional setting, this is a must-see property.

Nearby Attractions:

- High Wycombe Train Station = 2.6 miles
- Great Missenden Train Station = 4.8 miles
- Hughenden Manor Nation Trust = 2.3 miles
- Village shop/pub (walk) = 0.5 miles
- Roald Dahl Museum and Great Missenden village centre = 4.7 miles
- Hazlemere Village Shops (Costa/Butchers/Chip Shop/Coop) = 1.8 miles
- High Wycombe Town Centre = 2.7 miles
- Amersham = 7.7miles

What we love:

At Bucks Property, we have been involved in this development since the first phase was launched some years ago. We also manage the site - meaning that we know just about everything there is to know about the history, the site itself and how the site has been constructed! We love the peaceful nature of the site, the quality of the finish in each apartment and the views across Hughenden Valley from the entrance area. The garden within this property is South Facing will be perfect for entertaining or catching some sun.



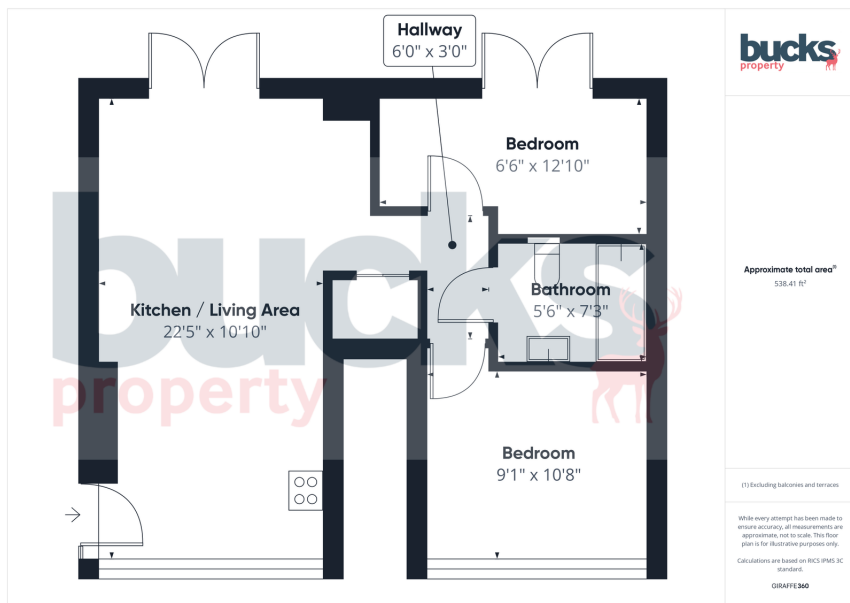

- Prime Location: Set in the East Wing of an exclusive South Buckinghamshire development, surrounded by nature.
- Modern Kitchen: Quartz countertops, ample storage, and integrated appliances.
- Bright Bedrooms: Large windows overlooking landscaped gardens.
- Historic Charm: Built within the grounds of a Grade II Listed country house in a unique setting.
- Bring your friends: Pets welcome.
- Elegant Design: Floor-to-ceiling windows and private patio and garden access.
- Spacious Living: Open-plan living room/kitchen.
- Luxury Bathroom: Italian marble and high-quality bathroom suite.
- Secure Complex: Gated with CCTV, parking, and a boutique feel.
- Excellent Transport: Train, tube, and motorways nearby.



bucksproperty.co.uk



1 Meadow Cottages | Little Kingshill | Great Missenden | Buckinghamshire | HP16 0DX
t. 07780 755590 | e. sales@bucksproperty.co.uk
Bucks Property Services Ltd Registered Number: 14869929

rightmove

B+hive

PRS

Inventory Hive

OnTheMarket