



2 Bed House - Terraced  
located in

**JR**  
JOSHUA REED  
Estate Agents



59 Olvega Drive  
Buntingford  
SG9 9FJ

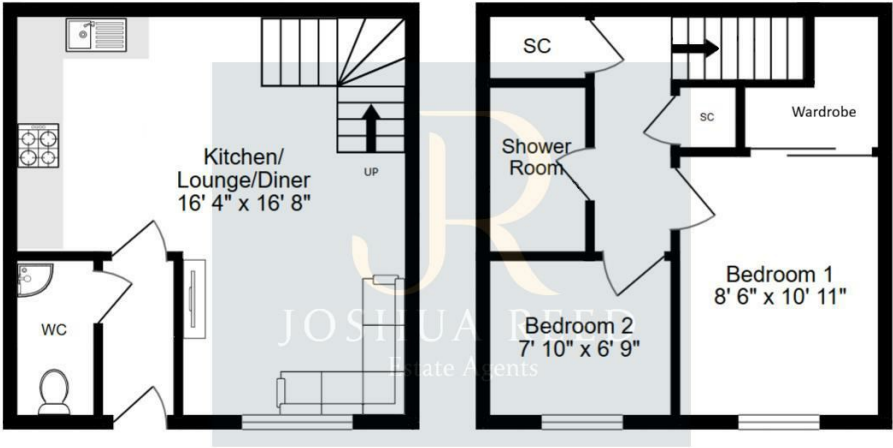

**Total Floor Area: 529 Sqft**  
All measurements are approximate and for display purposes only

Offers in excess of  
**£280,000**  
CONTACT

23-27 Maidenhead Street  
Hertford  
Hertfordshire  
SG14 1DW

EMAIL

[josh@joshua-reed.co.uk](mailto:josh@joshua-reed.co.uk)

TELEPHONE

01992 917388

[www.joshua-reed.co.uk](http://www.joshua-reed.co.uk)

SUMMARY

A beautifully presented, modern two bedroom cluster home nicely positioned in this cul-de-sac within walking distance to the Town Centre which offers an array of amenities. Finished to a high standard throughout, the accommodation offers an entrance porch, downstairs WC, modern gloss kitchen with integrated appliances that is open plan to the living and dining space. To the first floor are two good size bedrooms with built in wardrobes to the master, contemporary shower room, storage cupboard on the landing and access to loft space.

Additionally, the property benefits from gas central heating, UPVC double glazing, allocated parking space, secure residents bike store and children's play area nearby. To be sold CHAIN FREE.

Arrange your viewing today.

DIRECTIONS

