

5 Bed House - Detached
located in

JR
JOSHUA REED
Estate Agents

44 Walker Grove
Hatfield
AL10 9PL

5

3

2

C

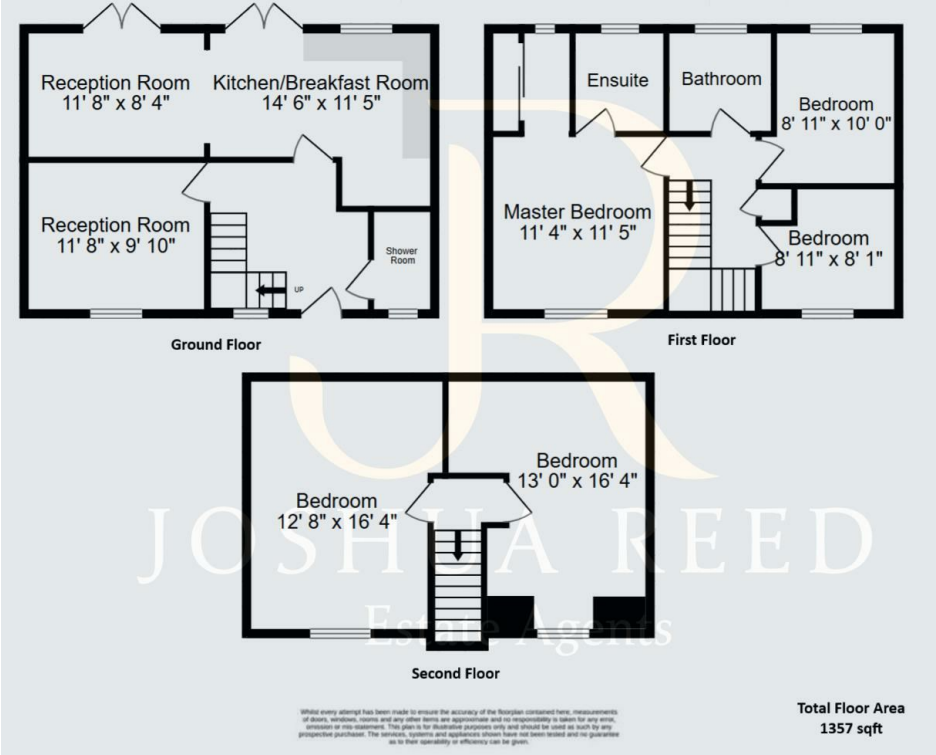

£539,995

CONTACT

23-27 Maidenhead Street
Hertford
Hertfordshire
SG14 1DW

EMAIL

josh@joshua-reed.co.uk

TELEPHONE

01992 917388

www.joshua-reed.co.uk

SUMMARY

PRICED FOR QUICK SALE - A five bedroom detached family house located on this popular residential development close to many amenities including The Hatfield Galleria, David Lloyds Leisure Centre and Herts University. The ground floor accommodation features an entrance hallway, modern shower room, two reception rooms and kitchen/diner with patio doors leading out to the garden.

The first floor benefits a large dual aspect master bedroom with dressing area, integrated wardrobes and en-suite, second double bedroom, third single bedroom and main family bathroom. To the top floor there is two further double bedrooms.

Externally, you will find a low maintenance rear garden with walled boundary and rear access, garage to the side with parking in front. The property is currently with vacant possession and to be sold with no onward chain.

Arrange an immediate viewing today.

DIRECTIONS

