



4 Bed House - Detached
located in

JR
JOSHUA REED
Estate Agents

47 Albury Ride
Cheshunt
EN8 8XE



4



3



4



E

Offers in excess of
£850,000
CONTACT

23-27 Maidenhead Street
Hertford
Hertfordshire
SG14 1DW

EMAIL

josh@joshua-reed.co.uk

TELEPHONE

01992 917388

www.joshua-reed.co.uk

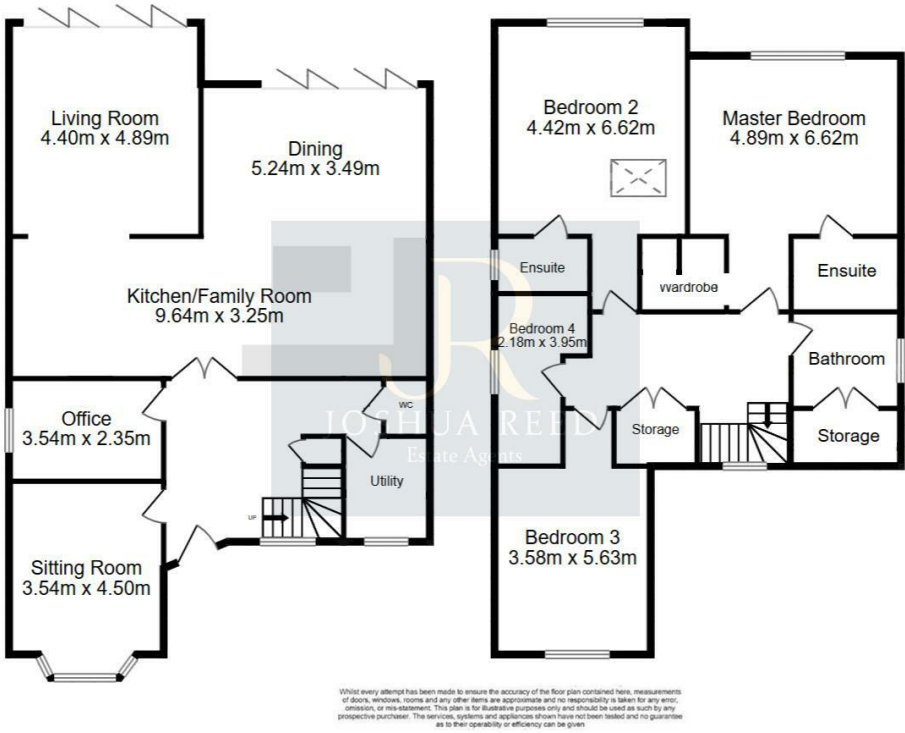

SUMMARY

A four/five bedroom detached family home situated in a highly sought after road walking distance from the High Street and Train Station. The property has undergone an extensive high end renovation throughout, new layout and now provides a truly incredible amount of living space, over 2800sqft.

The accommodation features a welcoming entrance hallway, stunning, fully integrated luxury kitchen which is open plan to a dining area plus snug/family area with bi-folds out to the garden, living room also with bi-folds, further reception/bedroom to the front, office/study, underfloor heating, downstairs WC and utility room.

To first floor is an impressive master bedroom with walk in wardrobe and ensuite, fantastic size second bedroom also with ensuite, two further double bedrooms and luxury family bathroom.

Externally, the south facing rear garden has been landscaped entirely with beautiful outdoor patio tiles, new lawn and shrubbery with side and rear access to the garage. Off street parking to the front and rear driveways.

DIRECTIONS

