



4 Bed House  
located in

**JR**  
JOSHUA REED  
Estate Agents



4 Spellbrook Farm Barns,  
London Road  
Bishops Stortford  
CM23 4AX



£950,000

CONTACT

23-27 Maidenhead Street  
Hertford  
Hertfordshire  
SG14 1DW

EMAIL

josh@joshua-reed.co.uk

TELEPHONE

01992 917388

www.joshua-reed.co.uk

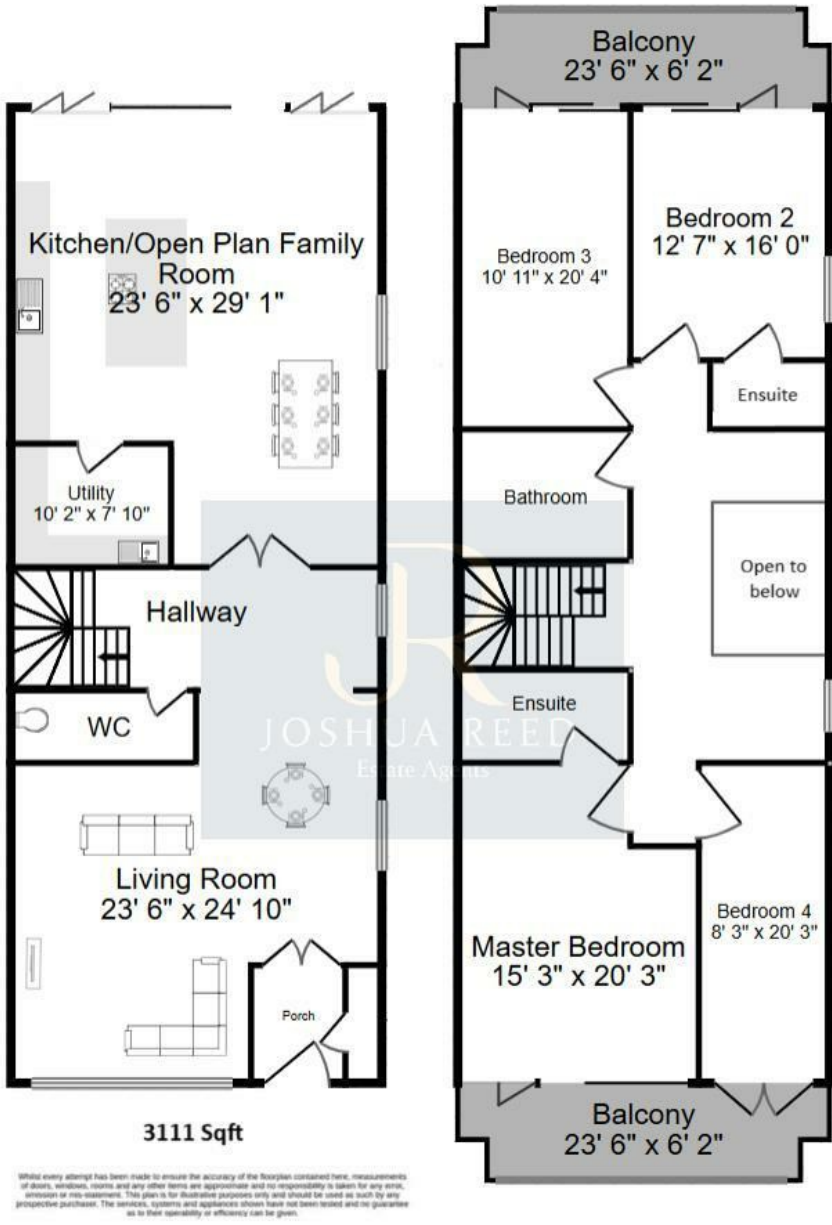

SUMMARY

A fabulous, brand new development of four contemporary barn conversions nicely positioned in the picturesque village of Spellbrook on the outskirts of Bishop's Stortford. The Barns are located at the end of a private driveway that provides panoramic views over the surrounding countryside.

With over 3100 sqft of accommodation that has been meticulously designed throughout, the highlights feature a stunning, open plan bespoke kitchen/family room with bi-folding doors onto the garden, a great room for entertaining. Separate utility room, ground floor cloakroom, great size living room and impressive hallway.

To the first floor you will find a beautiful galleried landing with imposing skylight, four good size double bedrooms, two with luxury ensembles plus additional family bathroom. Each bedroom has a balcony, two of which with stunning views overlooking the open countryside behind. Landscaped front and rear gardens, allocated parking with EV chargers. New Build Warranty.

DIRECTIONS

