



4 Bed House
located in

JR
JOSHUA REED
Estate Agents

1 Spellbrook Farm Barns,
London Road
Bishops Stortford
CM23 4AX



£995,000

CONTACT

23-27 Maidenhead Street
Hertford
Hertfordshire
SG14 1DW

EMAIL

josh@joshua-reed.co.uk

TELEPHONE

01992 917388

www.joshua-reed.co.uk

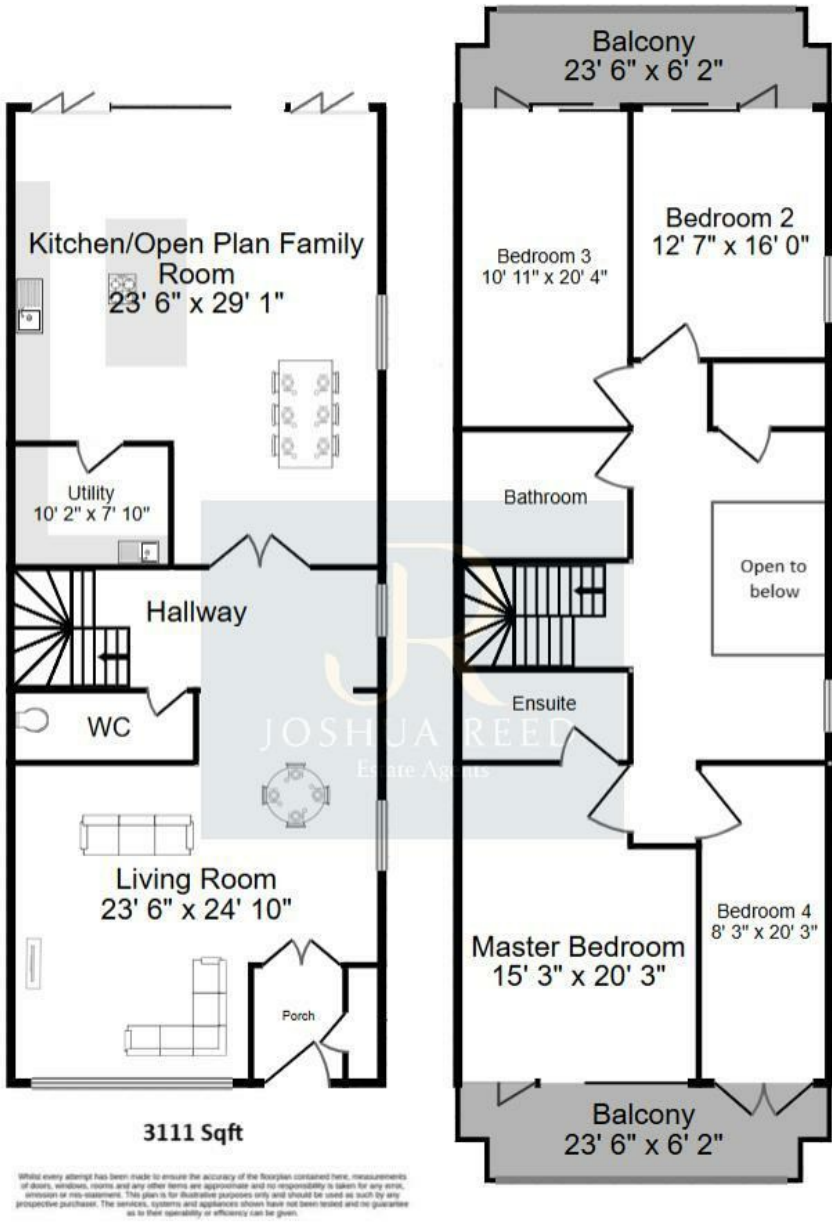

SUMMARY

BRAND NEW DEVELOPMENT - BARN CONVERSIONS

'Spellbrook Barns' - Consisting of four contemporary barn conversions nicely positioned in the picturesque village of Spellbrook on the outskirts of Bishop's Stortford. The Barns are located at the end of a private driveway that provides panoramic views over the surrounding countryside.

With over 3100 sqft of accommodation that has been meticulously designed throughout, the highlights feature a stunning, open plan bespoke kitchen/family room with bi-folding doors onto the garden, a great room for entertaining. Separate utility room, ground floor cloakroom, great size living room and impressive hallway.

To the first floor you will find a beautiful galleried landing with imposing skylight, four good size double bedrooms, two with luxury ensembles plus additional family bathroom. Each bedroom has a balcony, two of which with stunning views overlooking the open countryside behind.

DIRECTIONS

