



5 Bed House - Detached
located in

R
JOSHUA REED
Estate Agents

3 Owles Lane
Buntingford
SG9 9JA



5



4



3



E

Offers in excess of
£800,000
CONTACT

23-27 Maidenhead Street
Hertford
Hertfordshire
SG14 1DW

EMAIL

josh@joshua-reed.co.uk

TELEPHONE

01992 917388

www.joshua-reed.co.uk

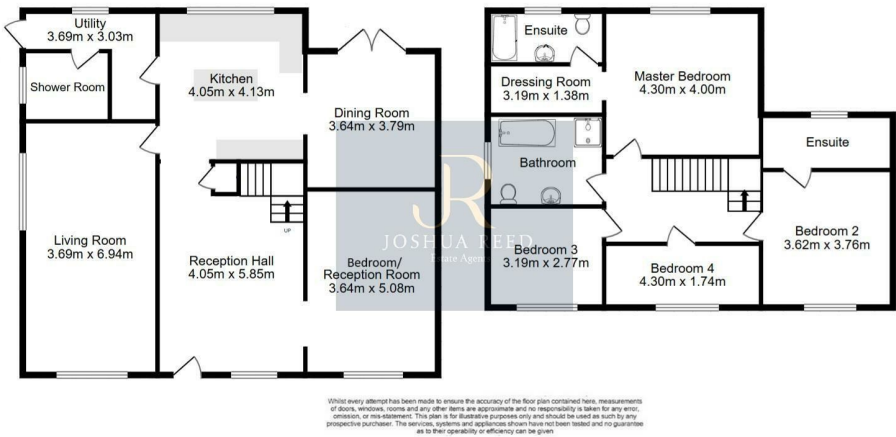

SUMMARY

A truly spectacular four/five bedroom detached property situated on this imposing raised plot adjacent to the countryside and just a short walk to Buntingford High Street. The accommodation has been meticulously designed with a tremendous feel of luxury and comfort throughout.

The centre point of the house is the beautiful kitchen with central island leading onto a convenient utility room and contemporary shower room. A real feature of the property is the versatility of the accommodation with two living/sitting rooms, one with open fireplace, separate dining room leading out to the garden all of which joined by an impressive entrance hall.

To the first floor you will find four generously proportioned bedrooms to include the principle bedroom suite complete with dressing room and luxury ensuite, further ensuite to bedroom number two and stunning family bathroom with stand alone bath tub and rejuvenating shower.

DIRECTIONS

