



Park Lane, Medlar With Wesham, PR4 3HG

Offers in the region of £260,000



56 Park Lane, Medlar With Wesham, PR4 3HG

Offers in the region of £260,000



Front Of Property

The front drive offers space for two cars and access to garage. There is a paved walkway and stone gravel area to the front also.

Porch

Access from main driveway with access to inner hallway and garage.

Inner Hallway

Welcoming area with access to all lower level rooms and upper rooms and comes with gas central heating.

Lounge

Great size living area with gas central heating and double glazing. The room also has the benefit of an gas wall mounted fire with access to the dining room.

Dining Room

Great sized dining room comes with French doors leading to the rear and has the benefit of gas central heating and access door to the kitchen.

Kitchen

Fabulous modern kitchen with a range of wall and base units and plenty of worktop space. The kitchen comes with a host of built in appliances such as a full size fridge and separate freezer and dishwasher. The kitchen also has an induction hob with built in oven and microwave. There is tiled flooring throughout and has a large double glazed window with tremendous views to the rear.

Shower Room

Three piece modern suite with walk in electric shower cubicle, Low flush WC and mixer tap wash hand basin. There room is fully tiled and comes with gas central heating and double glazed opaque window.

Bedroom One

A double bedroom with storage space along with gas central heating and double glazed window to the rear

Bedroom Two

Good size double room with built in storage space. The room has the benefit of gas central heating and double glazed window overlooking the front of the property.

Downstairs Bedroom Three

Good size double room with storage space and gas central heating with a double-glazed window overlooking the rear garden

Bedroom Four

Double bedroom with good storage space and gas central heating with a double glazed window which comes with excellent views over the rear garden.

Shower Room

Modern shower room with a three piece suite. The shower room consist of a walk in electric shower and a low flush WC along with a built in mixer tap wash hand basin and storage space. The room is fully tiled and comes with an opaque double glazed window and gas central heating.

Garage

Good size garage with an electric up and over door, power and light, wall mounted boiler with an access door leading into the rear garden. There is also plumbing for a washing machine and space for a dryer too.

Rear Garden

Great size rear garden which is mainly lawned and comes with a patio area to the rear which has a summer house. The rear garden is private not overlooked and comes with some spectacular views.

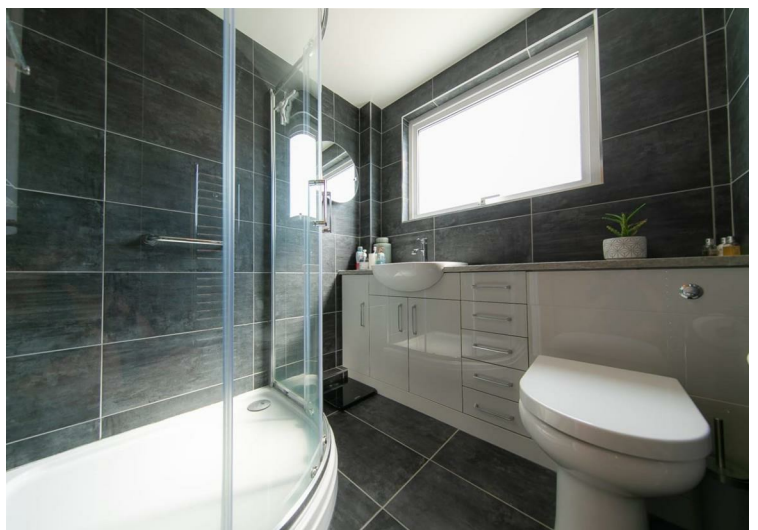

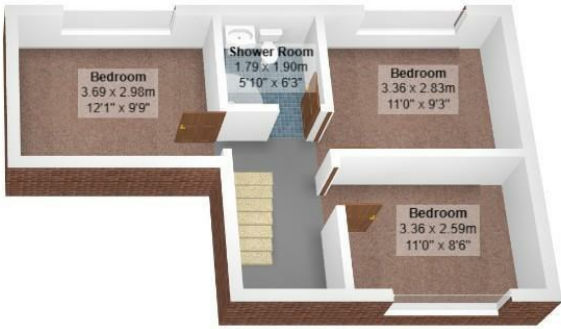
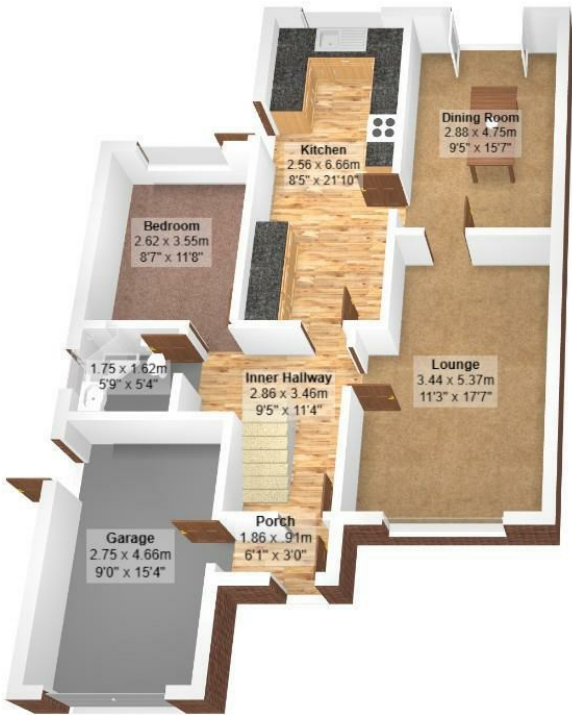
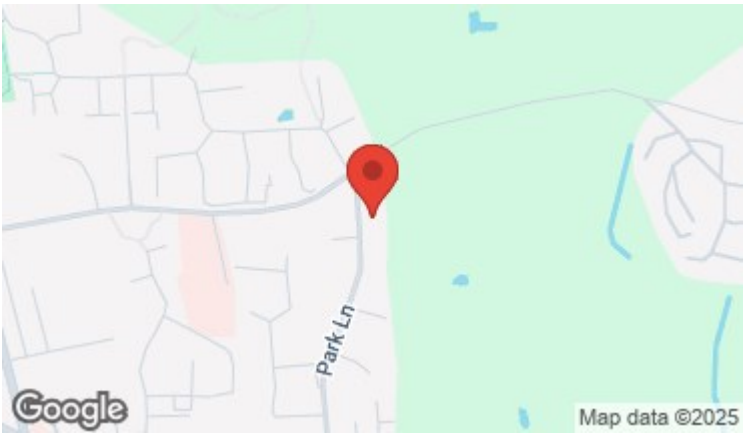

Total Area: 128.9 m² ... 1388 ft²

All measurements are approximate and for display purposes only

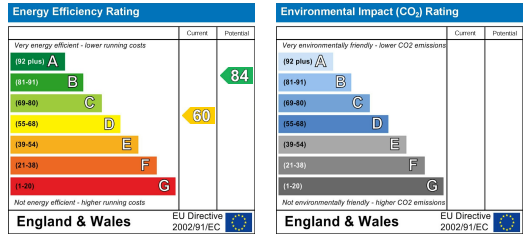

These particulars, whilst believed to be accurate are set out as a general outline only for guidance and do not constitute any part of an offer or contract. Intending purchasers should not rely on them as statements of representation of fact, but must satisfy themselves by inspection or otherwise as to their accuracy. No person in this firms employment has the authority to make or give any representation or warranty in respect of the property.