



Neale Close | London | N2

£430 Per Week |

 1  1  1  D

ADN
RESIDENTIAL

A modern one double bedroom ground floor maisonette located in East Finchley. The property benefits from having a large reception, a separate fully fitted kitchen, generous principal bedroom and a family bathroom. Further benefits include wooden flooring and sole use of the rear and front gardens.

-
- One Bedroom
 - Reception Room
 - Front & Rear Gardens
 - Wooden Flooring
 - Modern Kitchen
 - Bathroom
 - Permit Parking
-

Council Tax Band: C
EPC: C





Neale Close,
Hampstead Garden Suburb, N2

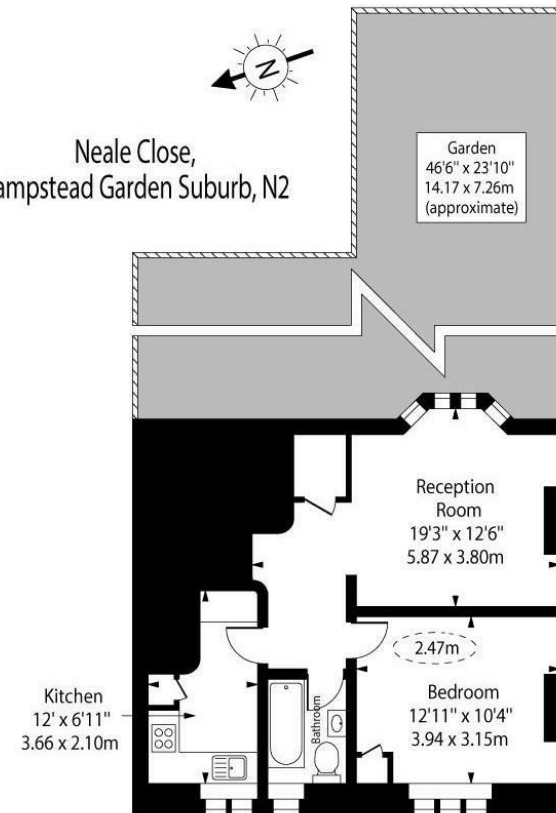

Ground Floor

Approx Gross Internal Area 480 Sq Ft - 44.60 Sq M

For Illustration Purposes Only - Not To Scale

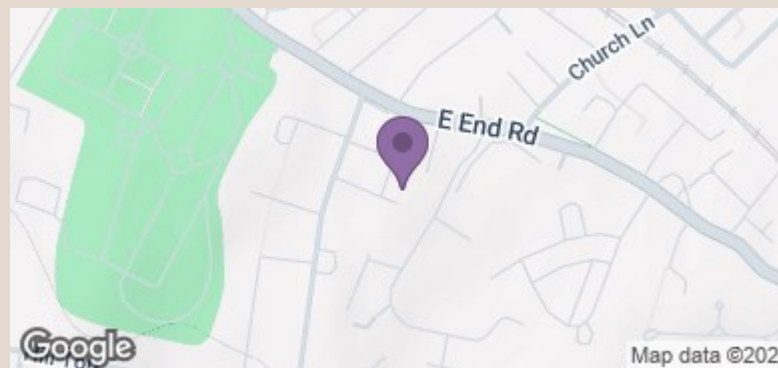

Energy Efficiency Rating		Current	Potential
Very energy efficient - lower running costs			
(92 plus)	A		
(81-91)	B		
(69-80)	C		
(55-68)	D		
(39-54)	E		
(21-38)	F		
(1-20)	G		
Not energy efficient - higher running costs			
England & Wales		67	77
EU Directive 2002/91/EC			

info@adnresidential.co.uk | 020 7407 5155