



Flat

**Winchester Road
Swiss Cottage
London
NW3 3NE**

£750 Per week

Council Tax Band: E

FEATURES

- 30 Ft Private Roof Terrace
- 24 Hour Concierge
- Open Plan Kitchen/Reception Room
- One Bedroom
- 2 Bathrooms
- Wooden Flooring

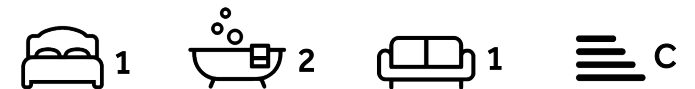

ADN
RESIDENTIAL



1 Bedroom Flat located in London

A stunning and well presented one bedroom apartment situated on the ninth floor of a popular block benefitting from 24 hour concierge. This bright apartment offers 721 sq ft of well planned accommodation and comprises, open plan kitchen/reception with access onto a generous private terrace, principal bedroom with built in storage and en-suite shower room, good storage and an additional bathroom. Further benefits include wooden flooring and double glazed windows.



The Visage, NW3

Approximate Gross Internal Area = 721 sq ft / 67.0 sq m

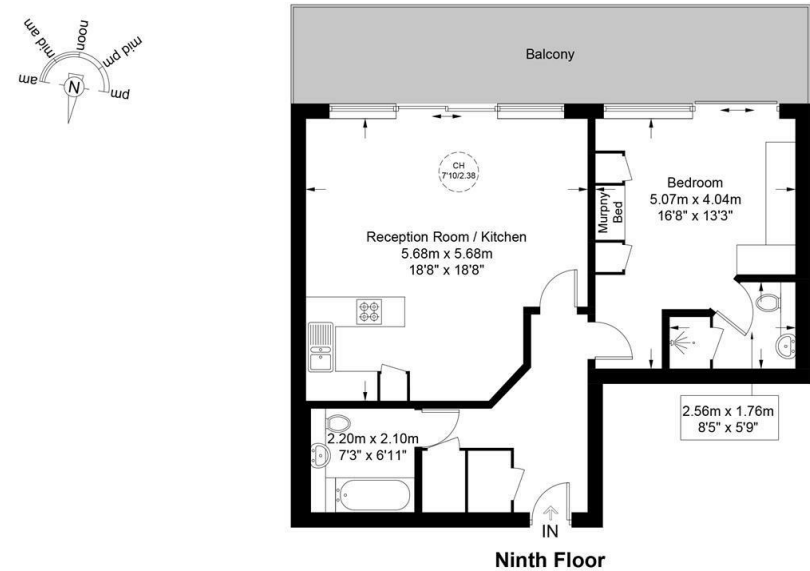

Energy Efficiency Rating		
	Current	Potential
Very energy efficient - lower running costs		
(92 plus) A		
(81-91) B		84
(69-80) C	71	
(55-68) D		
(39-54) E		
(21-38) F		
(1-20) G		
Not energy efficient - higher running costs		
England & Wales	EU Directive 2002/91/EC	

Call us on
020 7407 5155

info@adnresidential.co.uk
www.adnresidential.co.uk



This plan is for layout guidance only and is not drawn to scale unless stated. All dimensions, including windows, doors, and the Total Gross Internal Area (GIA), are approximate. For precise measurements, please consult a qualified architect or surveyor before making any decisions based on this plan.



Agents Note: Whilst every care has been taken to prepare these particulars, they are for guidance purposes only. All measurements are approximate and are for general guidance purposes only and whilst every care has been taken to ensure their accuracy, they should not be relied upon and potential buyers are advised to recheck the measurements.

