



Apartment

**Belsize Park Gardens**  
**Belsize Park**  
**London**  
**NW3 4ND**

**£1,730 Per week**

Council Tax Band: G

FEATURES



**ADN**  
RESIDENTIAL





# 2 Bedroom Apartment located in London

A stunning two bedroom apartment tucked away on one of Belsize Park's most desirable avenues offering 1147 sq ft of well planned accommodation. This fantastic property is finished to a high standard and comprises; spacious reception room with bay window and conservatory, separate fully fitted kitchen, large principal bedroom, second bedroom, family bathroom and a guest W.C.

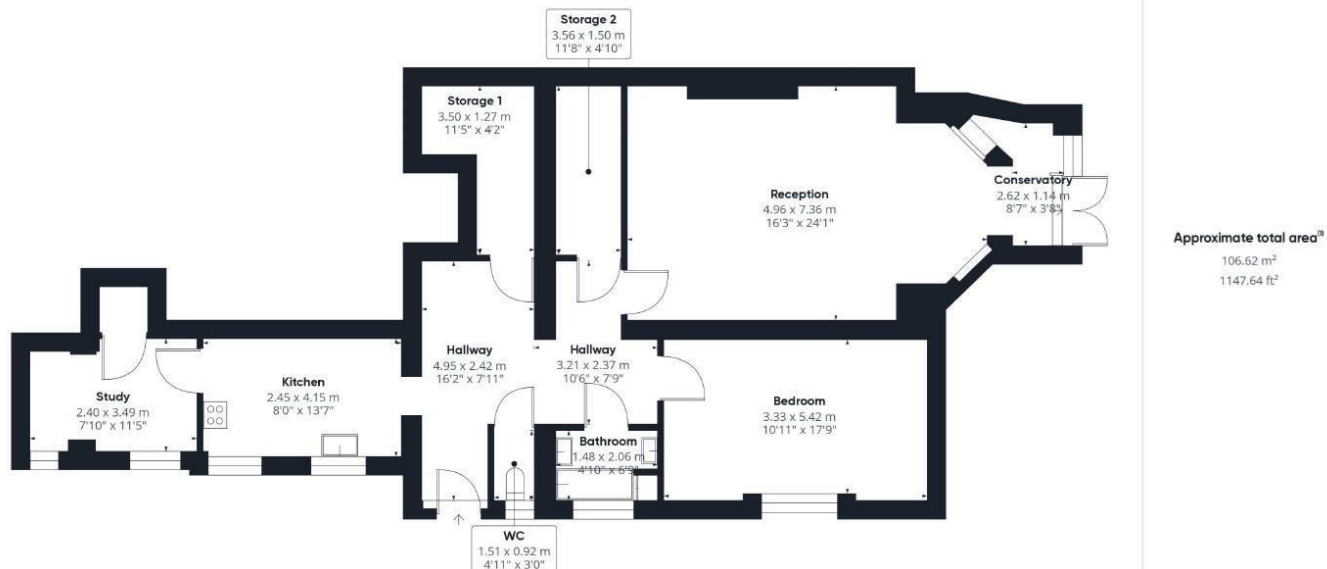

Energy Efficiency Rating		
	Current	Potential
Very energy efficient - lower running costs		
(92 plus) A		
(81-91) B		81
(69-80) C	68	
(55-68) D		
(39-54) E		
(21-38) F		
(1-20) G		
Not energy efficient - higher running costs		
England & Wales		EU Directive 2002/91/EC

Call us on

020 7407 5155

info@adnresidential.co.uk

www.adnresidential.co.uk

Agents Note: Whilst every care has been taken to prepare these particulars, they are for guidance purposes only. All measurements are approximate and are for general guidance purposes only and whilst every care has been taken to ensure their accuracy, they should not be relied upon and potential buyers are advised to recheck the measurements.

ADN  
RESIDENTIAL