

LEASEHOLD



Apartment

Finchley Road
Hampstead
London
NW3 7AT

Asking price
£800,000

Council Tax Band: E

FEATURES

- 2 Bedrooms
- Open Plan Kitchen/Reception Room
- 2 Bathrooms
- Terrace
- Underground Parking
- Concierge

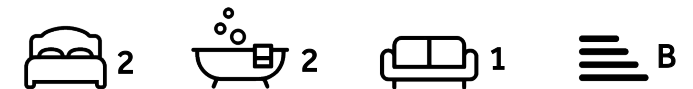

ADN
RESIDENTIAL



2 Bedroom Apartment located in London

An exceptional two double bedroom lateral apartment (938 sq ft / 86 sqm) with a private terrace situated on the first floor of a modern purpose built block with a lift, secure underground parking, landscaped communal gardens and concierge. This fantastic apartment, finished to a high specification with underfloor heating throughout, features a generous reception room with open plan kitchen leading onto the private terrace, principal bedroom with fitted wardrobes and en-suite shower room, second bedroom with fitted wardrobes and a family bathroom. Further benefits include wooden flooring and good storage throughout. Clark House forms part of Kidderpore Green, a modern luxury development built by Barratt London in 2016 and is well located for the fashionable boutiques and pavement cafes of Hampstead Village, and a short walking distance from excellent schools such as St Margaret's & St Luke's Church of England Primary School. The transport facilities on the Finchley Road (Metropolitan & Jubilee Line 1.1mile), West Hampstead (Thameslink 0.9 miles) together with the green expanses of Hampstead Heath.



Clark House, NW3

Approximate Gross Internal Area = 934 sq ft / 86.8 sq m

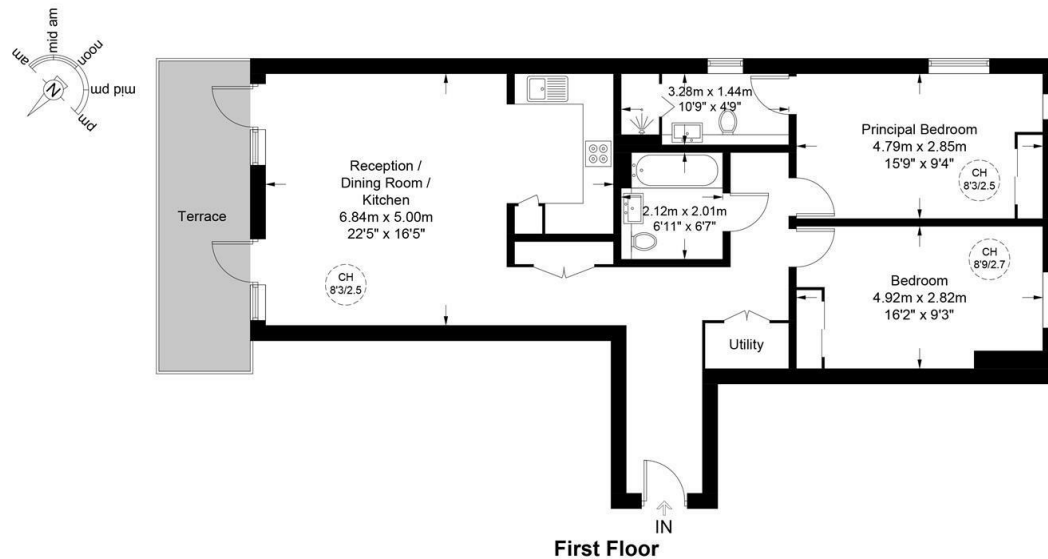

Energy Efficiency Rating		
	Current	Potential
Very energy efficient - lower running costs		
(92 plus) A		
(81-91) B	84	84
(69-80) C		
(55-68) D		
(39-54) E		
(21-38) F		
(1-20) G		
Not energy efficient - higher running costs		
England & Wales	EU Directive 2002/91/EC	

Call us on

020 7407 5155

info@adnresidential.co.uk

www.adnresidential.co.uk



This plan is for layout guidance only and is not drawn to scale unless stated. All dimensions, including windows, doors, and the Total Gross Internal Area (GIA), are approximate. For precise measurements, please consult a qualified architect or surveyor before making any decisions based on this plan.



Agents Note: Whilst every care has been taken to prepare these particulars, they are for guidance purposes only. All measurements are approximate and are for general guidance purposes only and whilst every care has been taken to ensure their accuracy, they should not be relied upon and potential buyers are advised to recheck the measurements.

