



2 Floors



3 Bedrooms



Utility



1 En suite

BYRON THREE BEDROOM HOME

A three bedroom semi-detached home with study and perfectly proportioned lounge and a stunning open plan kitchen / dining room with a separate utility area, cloakroom and French doors opening onto the rear garden. Upstairs the spacious master bedroom is complete with an en suite shower room.

BYRON THREE BEDROOM HOME

⬢ DIMENSIONS

First Floor:

Bedroom 1

3.44m x 2.93m
11'3" x 9'7"

En Suite

Bedroom 2

2.69m x 3.10m
8'10" x 10'2"

Bedroom 3

1.99m x 2.05m
6'6" x 6'9"

Bathroom

Ground Floor:

Lounge

3.75m x 4.38m
12'3" x 14'5"

Kitchen / Dining

3.63m x 3.69m
11'11" x 12'1"

(U) Utility

(C) Cloaks

◀▶ Measurement Points

△ External Access

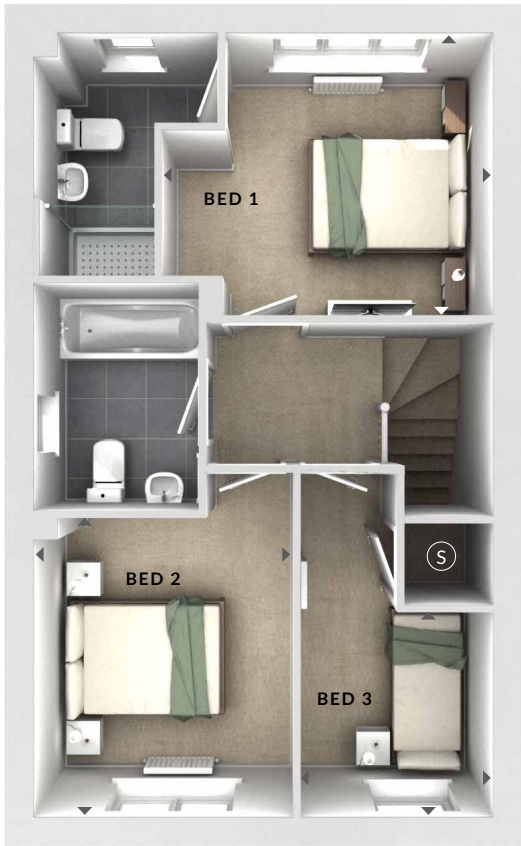

First Floor



Ground Floor