



75 Eastfield Road, Andover, SP10 1PB

Asking Price £270,000





75 Eastfield Road

Andover, SP10 1HE

- No onward chain
- Close to town
- One modern bathroom
- Charming terraced house
- Near schools and parks
- Driveway parking
- Two spacious bedrooms
- Two cosy reception rooms
- Older property with character
- Ideal for families

Nestled on the charming Eastfield Road in Andover, this delightful terraced house offers a perfect blend of character and comfort. With a generous living space of 849 square feet, this older property boasts two inviting reception rooms, ideal for both relaxation and entertaining. The two well-proportioned bedrooms provide a peaceful retreat, while the bathroom is conveniently located to serve the household's needs.

One of the standout features of this home is the absence of an onward chain, allowing for a smoother transition for potential buyers. The property is situated in a friendly neighbourhood, making it an excellent choice for first-time buyers, small families, or those looking to downsize.

With its traditional charm and practical layout, this house presents a wonderful opportunity to create a warm and welcoming home. Whether you are looking to invest in a property with character or seeking a comfortable living space in a desirable location, this terraced house on Eastfield Road is certainly worth considering.





Directions

Drive along the A3057 turn into Eastfiled Road and the property will be found on the left hand side.

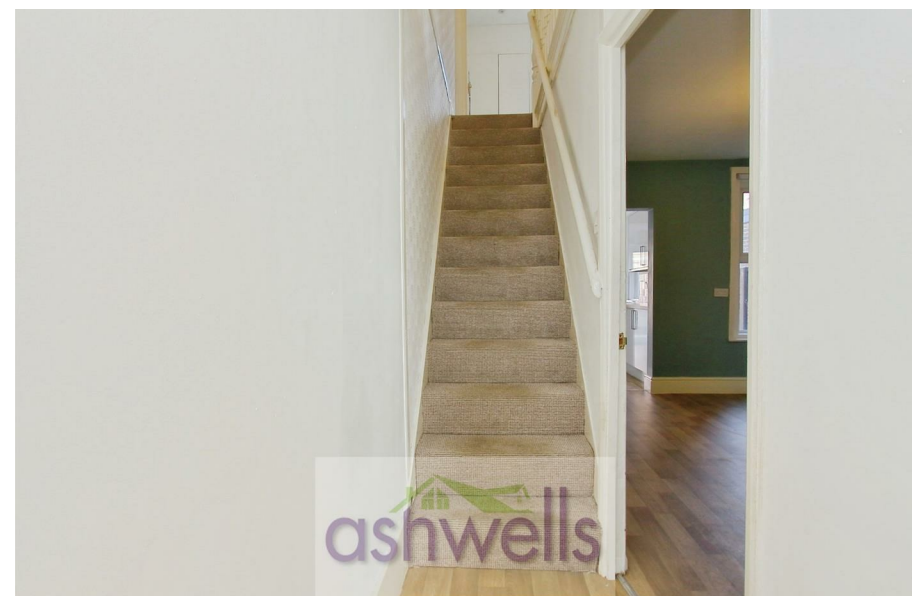



Floor Plans

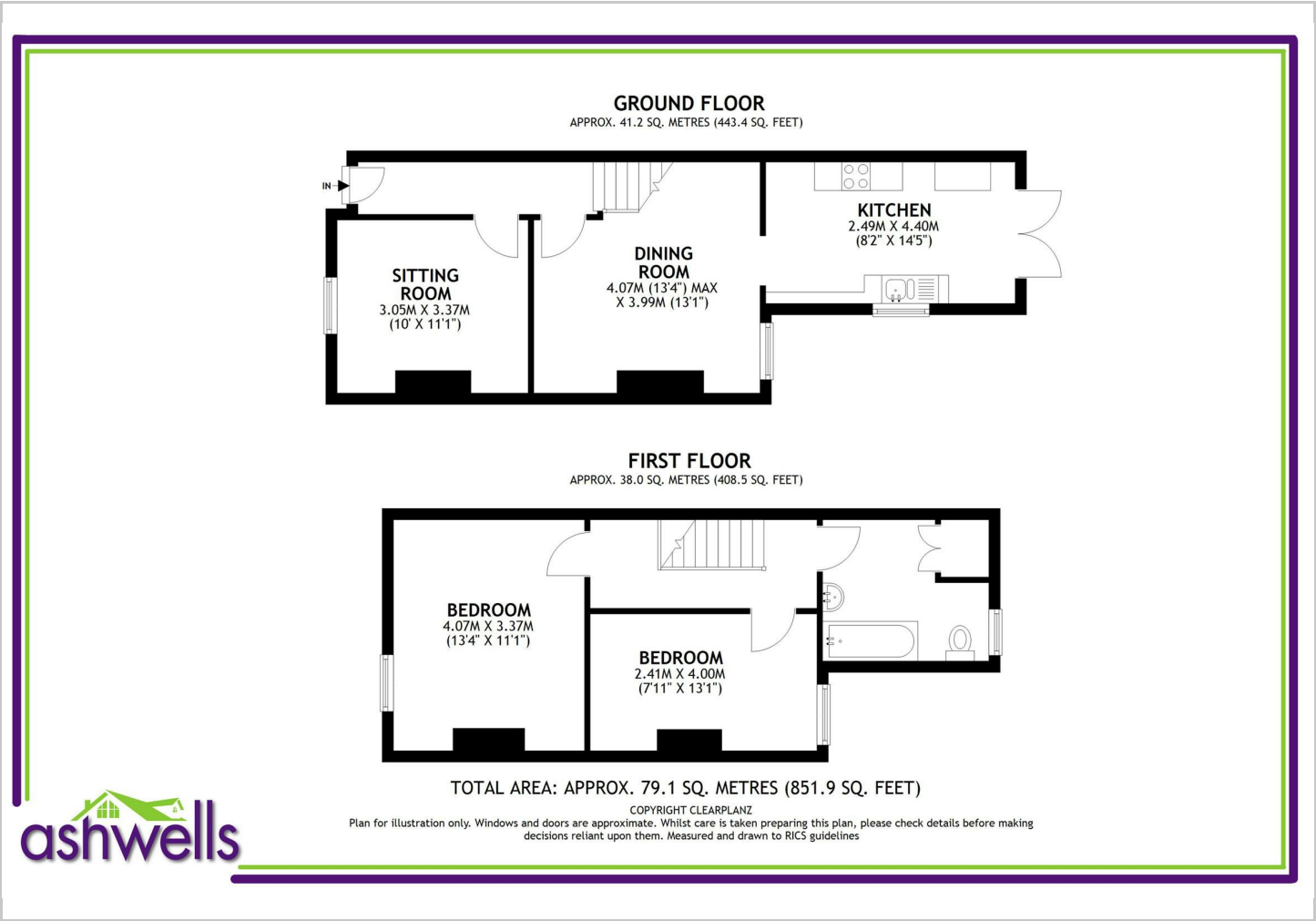

Viewing

Please contact our office on 01264 710776 if you wish to arrange a viewing appointment for this property or require further information.

The particulars are set out as a general outline only for the guidance of intended purchasers or lessees, and do not constitute, any part of a contract. Nothing in these particulars shall be deemed to be a statement that the property is in good structural condition or otherwise nor that any of the services, appliances, equipment or facilities are in good working order. Purchasers should satisfy themselves of this prior to purchasing.

Suite 520, Andover House George Yard, Andover, Hampshire, SP10 1PB
Tel: 01264 710776 Email: info@ashwellsestateagents.co.uk www.ashwellsestateagents.co.uk

Location Map



Energy Performance Graph

