



HOMES BY VICTORIA
ESTATE AGENCY

Hawling Street, Brockhill, Redditch, B97 6BP

Offers Over £375,000

4 2 2



A Double-Fronted Delight in Brockhill – Stylish, Spacious & Move-In Ready - Set within the ever-popular residential area of Brockhill, Redditch, this immaculately presented four-bedroom detached home offers the perfect blend of style, space, and superb convenience.

homesbyvictoria.co.uk

victoria@homesbyvictoria | 07833 136521

FOR M HOMES MIDLANDS LIMITED trading as Homes By Victoria Company Number: 13688840 VAT no: 470190115



HOMES BY VICTORIA
ESTATE AGENCY



HOMES BY VICTORIA

ESTATE AGENCY

Key Features

- STUNNING DETACHED FAMILY HOME
- MODERN KITCHEN DINER
- TWO RECEPTION ROOMS
- MASTER WITH EN-SUITE
- SINGLE GARAGE AND DRIVEWAY
- POPULAR RESIDENTIAL AREA OF BROCKHILL
- SEPERATE UTILITY ROOM
- DOWNSTAIRS WC
- FAMILY BATHROOM
- EPC B

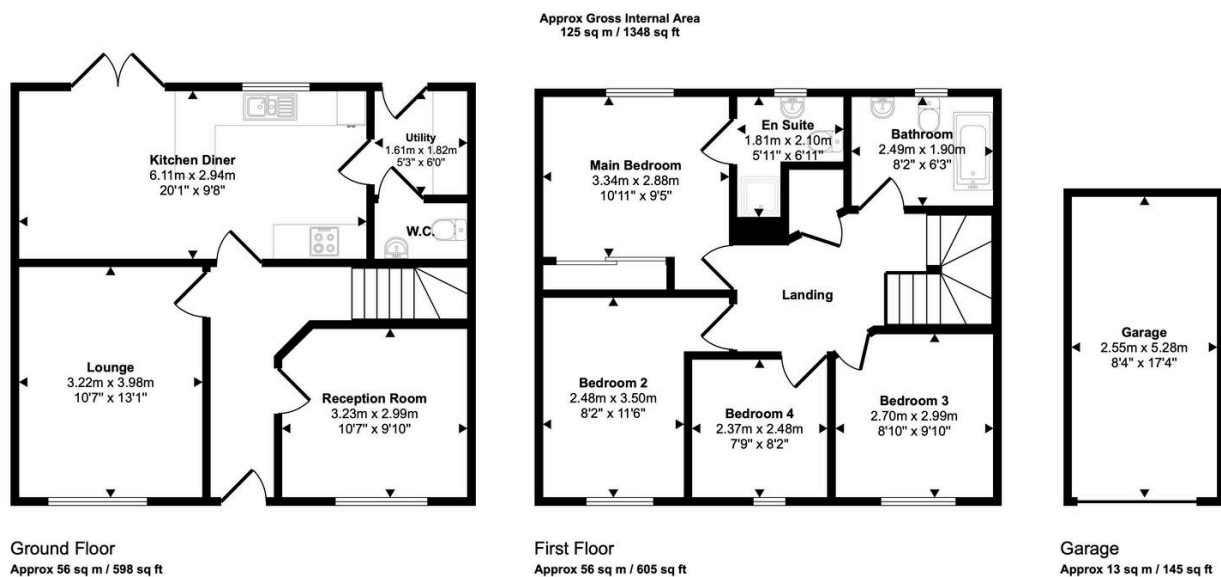

This floorplan is only for illustrative purposes and is not to scale. Measurements of rooms, doors, windows, and any items are approximate and no responsibility is taken for any error, omission or mis-statement. Icons of items such as bathroom suites are representations only and may not look like the real items. Made with Made Snappy 360.