



HOMES BY VICTORIA
ESTATE AGENCY

22 Wheelers Lane,

Offers Over £260,000

3 2 1



Stylish & Move-In Ready End-Terrace Home – Perfect for First-Time Buyers - Situated on the sought-after Wheelers Lane in Brockhill, this much-improved and beautifully presented end-of-terrace home is a true gem, ideal for first-time buyers looking for a modern, move-in-ready residence with plenty of style and comfort.

homesbyvictoria.co.uk

victoria@homesbyvictoria | 07833 136521

FOR M HOMES MIDLANDS LIMITED trading as Homes By Victoria Company Number: 13688840 VAT no: 470190115



HOMES BY VICTORIA
ESTATE AGENCY



HOMES BY VICTORIA

ESTATE AGENCY

Key Features

- LOCATED IN THE POPULAR AREA OF BROCKHILL
- MODERN AND TASTEFULLY DECORATED THROUGHOUT
- THREE BEDROOM END OF TERRACE HOME
- LOUNGE
- STUNNING INTEGRATED KITCHEN DINER
- DOWNSTAIRS WC
- MASTER BEDROOM WITH EN-SUITE
- FAMILY BATHROOM
- LOW MAINTENANCE REAR GARDEN
- SINGLE GARAGE AND OFF ROAD PARKING

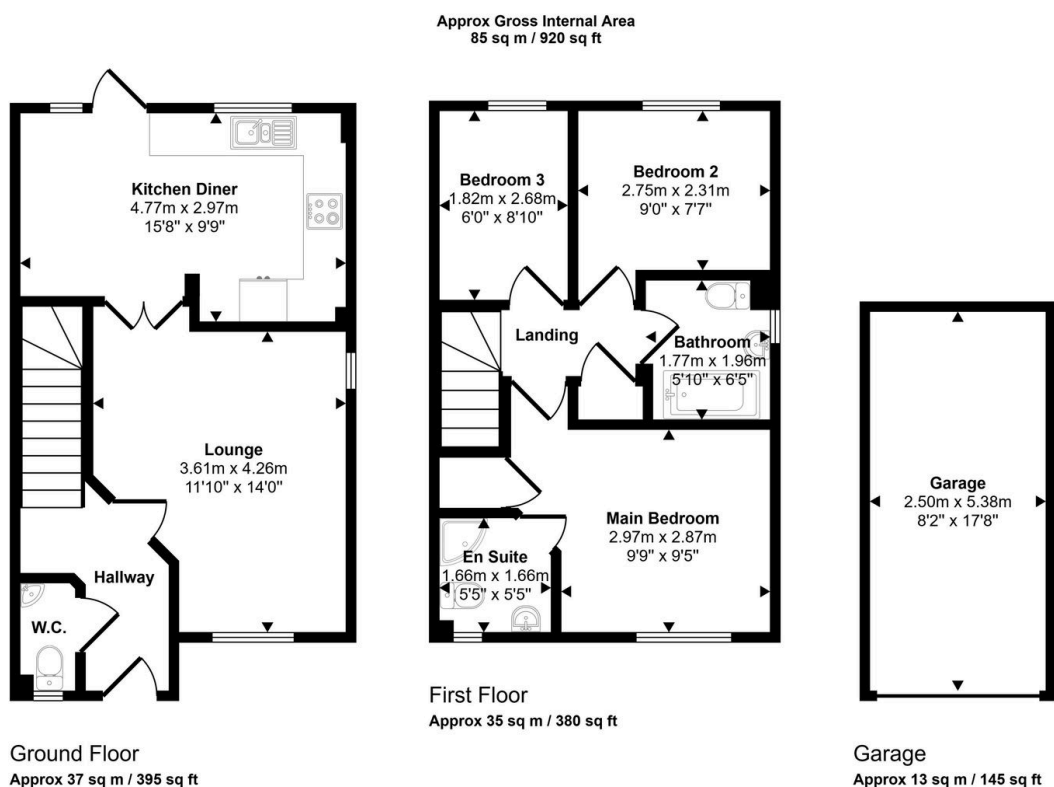

This floorplan is only for illustrative purposes and is not to scale. Measurements of rooms, doors, windows, and any items are approximate and no responsibility is taken for any error, omission or mis-statement. Icons of items such as bathroom suites are representations only and may not look like the real items. Made with Made Snappy 360.