



HOMES BY VICTORIA
ESTATE AGENCY

Granhill Close, Redditch, B98 7PS

Offers In Region Of £200,000

3 1 1



Spacious Split-Level Home in the Popular Greenlands Area – Full of Potential! Are you looking for a property that's ready to live in but offers the opportunity to make it your own? This spacious split-level home in the sought-after area of Greenlands is the perfect blank canvas. With generous proportions throughout, it presents a fantastic opportunity for those looking to add their personal touch and unlock its full potential and value.

homesbyvictoria.co.uk

victoria@homesbyvictoria | 07833 136521

FOR M HOMES MIDLANDS LIMITED trading as Homes By Victoria Company Number: 13688840 VAT no: 470190115



HOMES BY VICTORIA
ESTATE AGENCY



Key Features

- OFFERED TO THE MARKET CHAIN FREE
- POPULAR LOCATION OF GREENLANDS
- IN NEED OF SOME MODERNISATION
- SPLIT LEVEL LIVING
- PORCH ENTRANCE
- KITCHEN DINER
- LOUNGE
- THREE BEDROOMS
- SHOWER ROOM
- PRIVATE REAG GARDEN

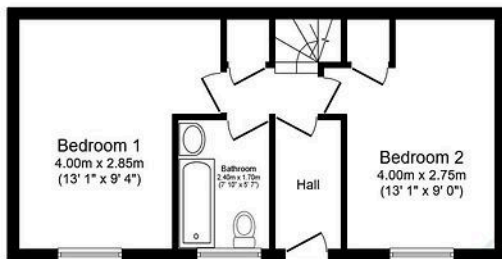

Ground Floor
Floor area 37.7 sq.m. (405 sq.ft.)



First Floor
Floor area 18.0 sq.m. (194 sq.ft.)

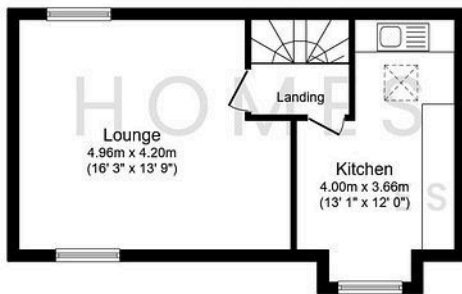

Second Floor
Floor area 35.4 sq.m. (381 sq.ft.)

Total floor area: 91.1 sq.m. (980 sq.ft.)

This floor plan is for illustrative purposes only. It is not drawn to scale. Any measurements, floor areas (including any total floor area), openings and orientations are approximate. No details are guaranteed, they cannot be relied upon for any purpose and do not form any part of any agreement. No liability is taken for any error, omission or misstatement. A party must rely upon its own inspection(s).