



HOMES BY VICTORIA
ESTATE AGENCY

Caynham Close, Redditch, B98 0JF

Offers Over £260,000

3 1 1



Situated in the highly desirable Winyates West area of Redditch, this move-in-ready three-bedroom semi-detached property is perfect for first-time buyers or those seeking a comfortable family home.

The property boasts light and airy open-plan entrance, lounge and diner effortlessly creating a welcoming and versatile space for modern living. With a separate stylish and contemporary kitchen offering a range of wall and base units, ample work surfaces and access to the rear garden is ideal for culinary enthusiasts.

Upstairs, the master bedroom is positioned to the rear aspect and is a true retreat, featuring built-in wardrobes. Two additional well-proportioned bedrooms provide flexibility for family, guests or home office needs. The family bathroom comprises a vanity low level wc and wash basin with storage, panelled bath with shower over and heated towel rail.

The property continues to impress with its outdoor features. The beautifully landscaped rear garden features a generous patio area, further decked area ideal for entertaining and a well maintained lawn, a perfect space for hosting summer barbecues or relaxing with family & friends. Convenient access to a utility area located at the rear of the garage, adding practicality to the home. A tandem garage providing ample space for storage or workshop and block paved driveway to the front.

Situated in Winyates West, the nearby town of Redditch offers easy access to motorway links (M42, Jct 2&3) and there are good rail and bus links. There are also excellent leisure facilities along with cultural attractions, and the Kingfisher Shopping Centre.



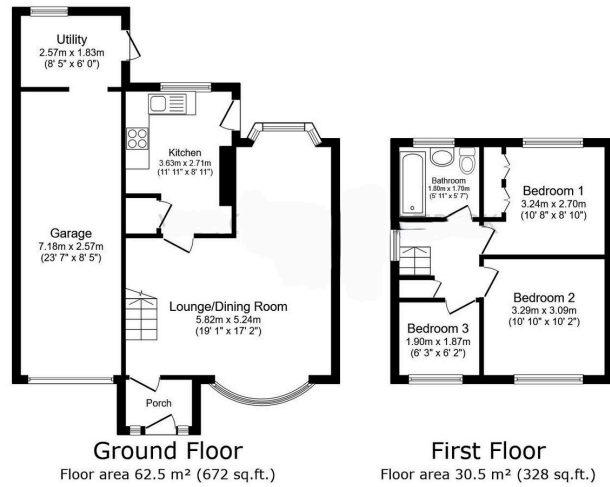

- POPULAR RESIDENTIAL LOCATION
- MOVE IN READY
- SEMI-DETACHED PROPERTY
- MODERN KITCHEN
- OPEN PLAN LIVING
- THREE BEDROOMS
- FAMILY BATHROOM
- DELIGHTFUL REAR GARDEN
- TANDEM GARAGE AND DRIVEWAY
- EPC C



homesbyvictoria.co.uk
victoria@homesbyvictoria | 07833 136521

FOR M HOMES MIDLANDS LIMITED trading as Homes By Victoria Company Number: 13688840 VAT no: 470190115



HOMES BY VICTORIA
ESTATE AGENCY