

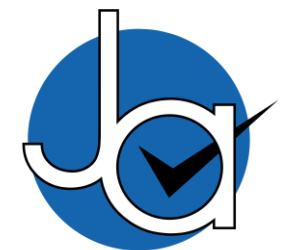

## 2 bedroom Semi-Detached House located in Manningtree

Guide Price  
£240,000 - £260,000

Find us on..



**JOHN ALEXANDER**  
ESTATE AGENTS



# Keating Close Manningtree CO11 2HF



2



1



1



EPC

C



## FULL DESCRIPTION

### THE OVERVIEW

\*\*\*Guide Price Of £240,000 - £260,000\*\*\*

Located in a desirable area of Lawford, this charming two-bedroom semi-detached house is beautifully presented throughout. The property features a spacious living/dining area, a modern kitchen, two bedrooms, and a bathroom. It also benefits from a garage, off-road parking, and a well-maintained garden.

### THE HOME

Upon entering the home you are greeted by a staircase that ascends to a tidy front garden and the entrance door. Living/Dining Room: The living and dining area welcomes you with natural light streaming through the window. It creates a warm, inviting space for relaxing evenings with family. Additionally, there is plenty of room for a dining table, making it an excellent setting for hosting friends.

Kitchen: The nearby kitchen is equipped with sleek grey gloss cabinets that beautifully reflect the natural light coming in through the window and door. From this space, you can also enjoy scenic views of the garden at the back.

Upstairs, you will find two spacious bedrooms, and completing the floor is a conveniently located family bathroom.

### THE OUTSIDE

The exterior of the property provides off-road parking alongside a detached garage, complemented by a tidy, well-maintained garden.

### THE LOCATION

The property is situated in Manningtree, Lawford, conveniently close to the village and within easy reach of local amenities.



## FLOORPLAN

GROUND FLOOR

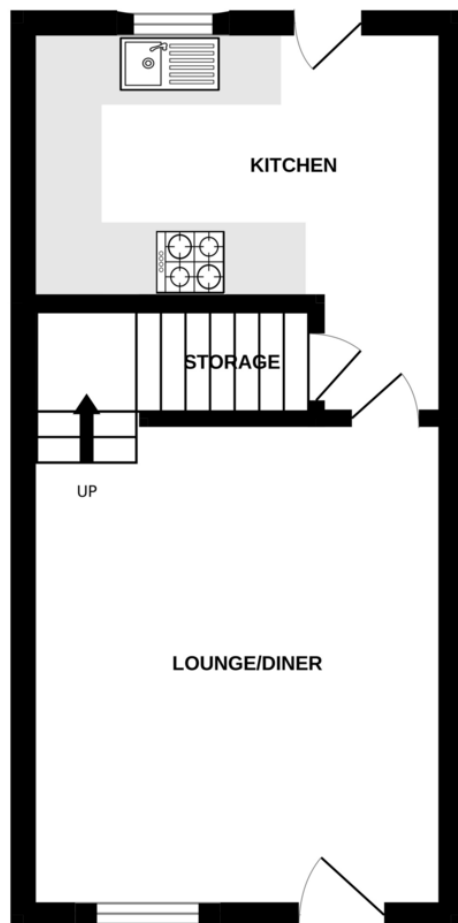

1ST FLOOR

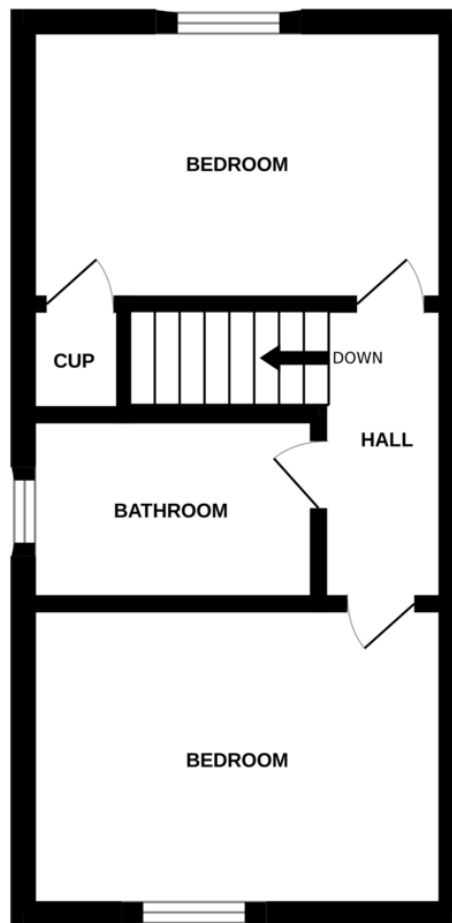

## DIRECTIONS

### CONTACT

**288 High Street**  
**Harwich**  
**Essex**  
**CO12 3PD**

**E [enquiries@john-alexander.co.uk](mailto:enquiries@john-alexander.co.uk)**

**T 01255 520007**

**[www.john-alexander.co.uk](http://www.john-alexander.co.uk)**

Find us on..

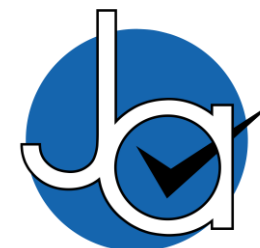

**JOHN ALEXANDER**  
**ESTATE AGENTS**

Whilst every attempt has been made to ensure the accuracy of the floorplan contained here, measurements of doors, windows, rooms and any other items are approximate and no responsibility is taken for any error, omission or mis-statement. This plan is for illustrative purposes only and should be used as such by any prospective purchaser. The services, systems and appliances shown have not been tested and no guarantee as to their operability or efficiency can be given.  
Made with Metropix ©2025