

LEASEHOLD



Flat

12 SIDCUP HILL GARDENS, SIDCUP HILL, SIDCUP, KENT, DA14 6JP

Asking price

£340,000

FEATURES

- TWO DOUBLE BEDROOM
- FIRST-FLOOR MAISONETTE
- LARGE LIVING/DINING ROOM
- CONTEMPORARY THREE PIECE SHOWER ROOM
- SHARED GARDEN
- DOUBLE GLAZING AND GAS CENTRAL HEATING
- BEAUTIFULLY PRESENTED THROUGHOUT
- MODERN FITTED KITCHEN
- QUIET CUL-DE-SAC LOCATION WITH CENTRAL GREEN AREA
- LONG LEASE PLUS LOW SERVICE CHARGES
- INTERNAL VIEWING RECOMMENDED



Westwood
PROPERTY SERVICES

2 Bedroom Flat located in Sidcup

Call us on

020 8301 5511

sales@westwoodpropertyservices.co.uk

SOLD VIA WESTWOOD SIDCUP. Located in the desirable location of Sidcup Hill Gardens is this larger than average two double bedroom maisonette. Beautifully presented throughout the accommodation offers good size rooms as well as a shared garden.

Council Tax Band

C

Sidcup Hill Gardens, DA14

Approximate Gross Internal Area 79.7 sq m / 858 sq ft

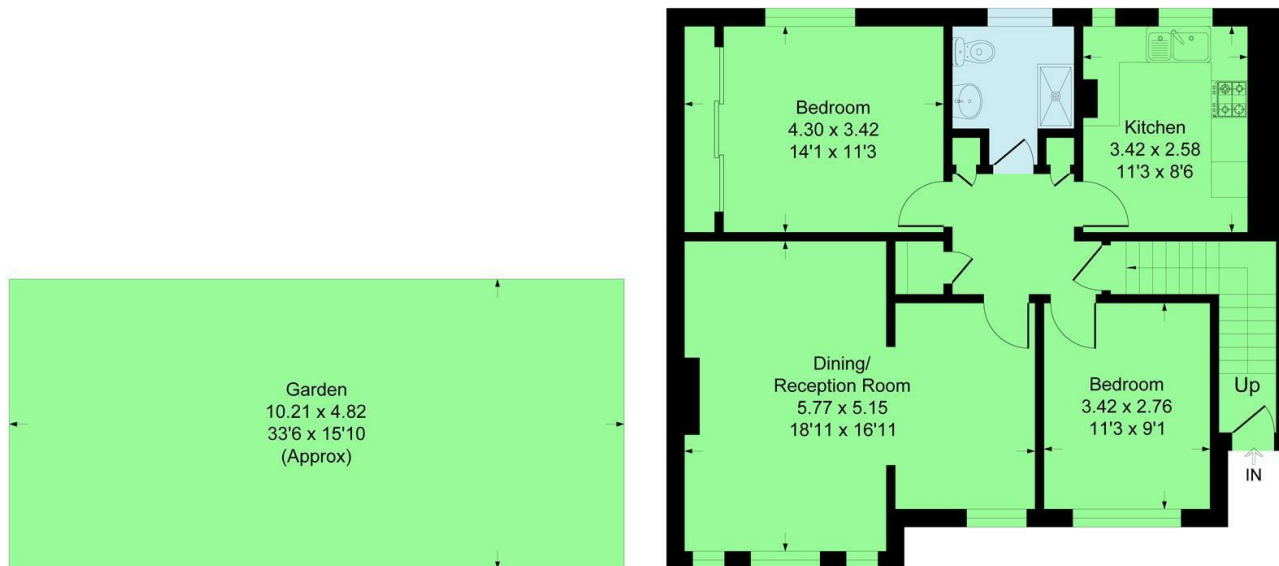

Energy Efficiency Rating		Current	Potential
<i>Very energy efficient - lower running costs</i>			
(92 plus) A			
(81-91) B			
(69-80) C		69	75
(55-68) D			
(39-54) E			
(21-38) F			
(1-20) G			
<i>Not energy efficient - higher running costs</i>			
England & Wales		EU Directive	EU
		2002/91/EC	

Agents Note: Whilst every care has been taken to prepare these particulars, they are for guidance purposes only. All measurements are approximate and are for general guidance purposes only and whilst every care has been taken to ensure their accuracy, they should not be relied upon and potential buyers are advised to recheck the measurements.

This plan is for layout guidance only. Not drawn to scale unless stated. Windows and door openings are approximate. Whilst every care is taken in the preparation of this plan, please check all dimensions, shapes and compass bearings before making any decisions reliant upon them.
Produced By Planpix

