

FREEHOLD



House - Mid Terrace

**21 ROWLEY
AVENUE, SIDCUP,
DA15 9LF**

Guide price

£400,000

FEATURES

- TWO BEDROOM EXTENDED MIDDLE TERRACED HOME
- BACKING ONTO PENHILL PARK
- GROUND FLOOR WC PLUS FIRST FLOOR SHOWER ROOM
- CHAIN FREE SALE
- LOW-MAINTENANCE REAR GARDEN



Westwood
PROPERTY SERVICES

2 Bedroom House - Mid Terrace located in Sidcup

****GUIDE PRICE £400,000 - £425,000**** Positioned on the popular and ideally located Rowley Avenue and backing onto Penhill Park, we are pleased to offer as a CHAIN FREE sale this well presented two bedroom middle terraced home. Having been thoughtfully extended and wall laid-out this home comprises entrance hall, through lounge, extended kitchen, GROUND FLOOR WC, two first floor bedrooms and a three piece shower room. The low maintenance rear garden has a gate with rear access and to the front there is a pattern imprinted driveway. Additional points of note include double glazing and gas central heating. An internal viewing comes highly advised.

Call us on
020 8301 5511
sales@westwoodpropertyservices.co.uk

Council Tax Band
C

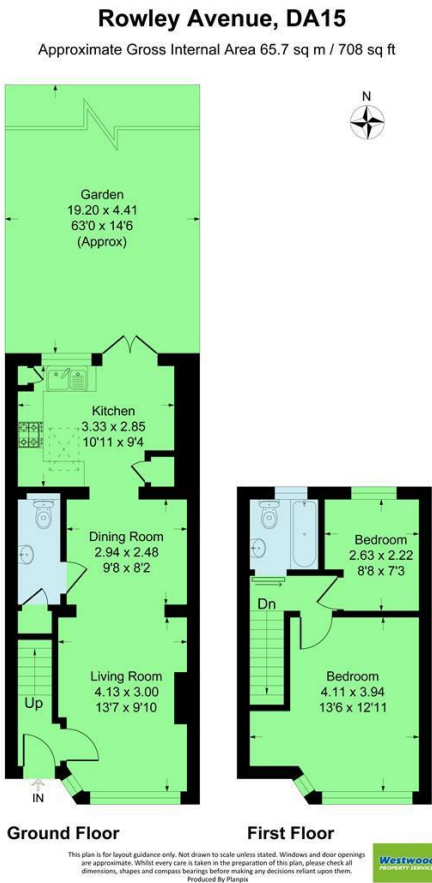

Energy Efficiency Rating		
	Current	Potential
Very energy efficient - lower running costs		
(92 plus) A		
(81-91) B		
(69-80) C		
(55-68) D		
(39-54) E		
(21-38) F		
(1-20) G		
Not energy efficient - higher running costs		
England & Wales		EU Directive 2002/91/EC

Agents Note: Whilst every care has been taken to prepare these particulars, they are for guidance purposes only. All measurements are approximate and are for general guidance purposes only and whilst every care has been taken to ensure their accuracy, they should not be relied upon and potential buyers are advised to recheck the measurements.

